



Configurable Panel - Code-free UI Creation Templates

Panel Development > Configurable Panel

Version: 20200218



Contents

1 Overview	1
2 Configuration Process	2
2.1 Functional Requirements of Products	2
2.2 Configuration Steps	2

1 Overview

The free configurable panel has the greatest degree of freedom. By using a code-free UI creation template, you can freely configure App UIs. You can select module shapes, icons, and background images for different data points (DPs), drag and sort DPs, and change the UI style.

The advantage is that the interface function modules are completely consistent with the created data points. The disadvantage is that the panel is completely modularized and lack of aesthetics. The free configurable panels are often used in the debugging phase of the project and are used as a temporary panel.

Attention: Free configured panel cannot display `RAW type` and `Fault type` functions.

2 Configuration Process

Take Wi-Fi multifunction sensor as an example.

2.1 Functional Requirements of Products

1. Supporting three modes: arming, disarming, and unattended. The arming mode enables detection and alarm; the disarming mode disables detection and alarm; the unattended mode enables detection but disables alarm.
2. Supporting three alarm modes: sound alarm, light alarm, and sound & light alarm.
3. Integrated detection and alarm of three concentration data types: VOC, PM2.5 and formaldehyde.
4. Smart scenes support timing function.

2.2 Configuration Steps

2.2.1 Set data points.

a) Check the standard data points in the following figure according to product requirements:

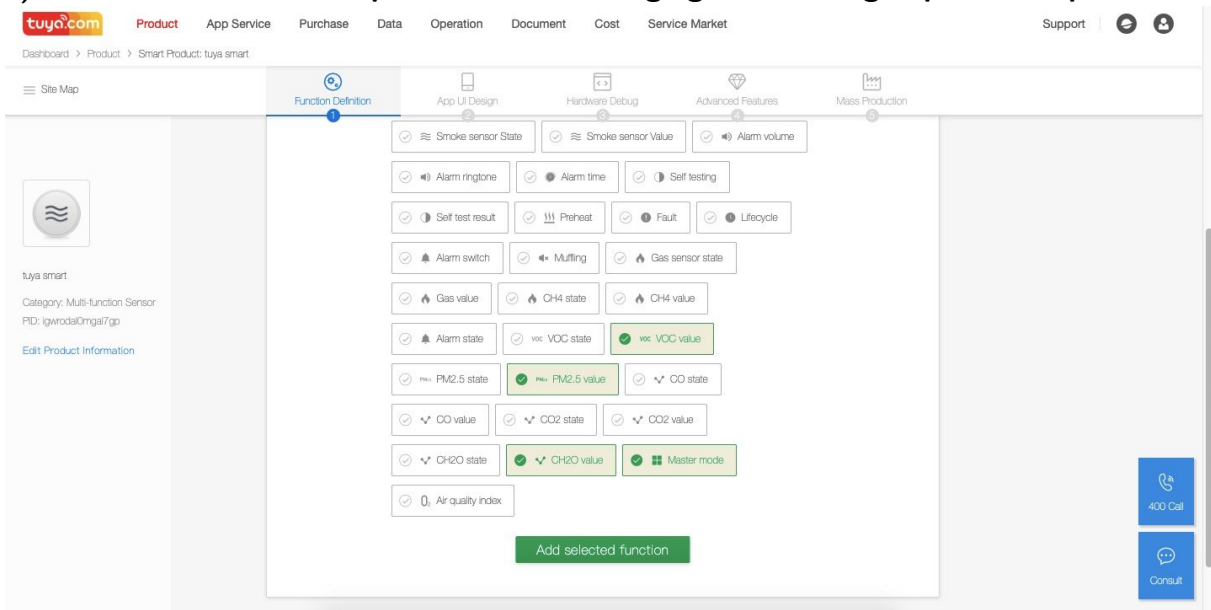

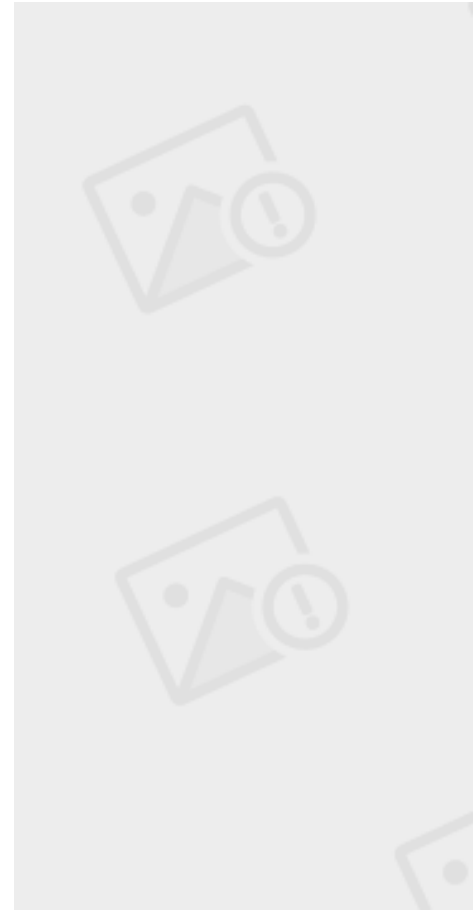

b) After determination, the details of data points are shown as follows:

c) Add the following custom data points according to product requirements. **Note:** Since the free configurable panel only display data point content, the cloud timing function will not be displayed on the free configured panel, but it will support setting timing in the “Scenario and Automation” in the App after enabled.



Configurable Panel - Code-free UI Creation Configuration Process

The screenshot displays the Tuya configuration interface for a product named 'tuya smart'. The interface includes a top navigation bar with tabs for 'Product', 'App Service', 'Purchase', 'Data', 'Operation', 'Document', 'Cost', and 'Service Market'. Below this is a breadcrumb trail: 'Dashboard > Product > Smart Product: tuya smart'. A secondary navigation bar contains icons for 'Function Definition', 'App UI Design', 'Hardware Debug', 'Advanced Features', and 'Mass Production'. The main content area is divided into two sections: 'Function Definitions' and 'Cloud Functions'. The 'Function Definitions' section contains a table with columns for DP ID, Function points, Identifier, Data type, Function type, Properties, Remark, and Operate. The 'Cloud Functions' section contains a table with columns for Function, Identifier, Function descriptions, and Operate. On the right side of the interface, there are two blue buttons: '400 Call' and 'Consult'.

DP ID	Function points	Identifier	Data type	Function type	Properties	Remark	Operate
101	VOC alarm	bt_voc	Issue and report	Boolean			Edit Delete
102	PM2.5 alarm	bt_pm25	Issue and report	Boolean			Edit Delete
103	CH2O alarm	bt_ch2o	Issue and report	Boolean			Edit Delete
104	alarm	alarm	Issue and report	Enum	Enumerated values:A1, A2, A3, A4		Edit Delete

Function	Identifier	Function descriptions	Operate
Fixed Time	timer	Tuya Cloud's timer function allows you to set on/off time, timer cycling, and other functions	On
Jumping page	jump_url	Settings for the web page url jumping function; can jump to mail, official website, or other pages. Add link	Off



d) After setting, choose the free configured panel, and the panel style is as follows:

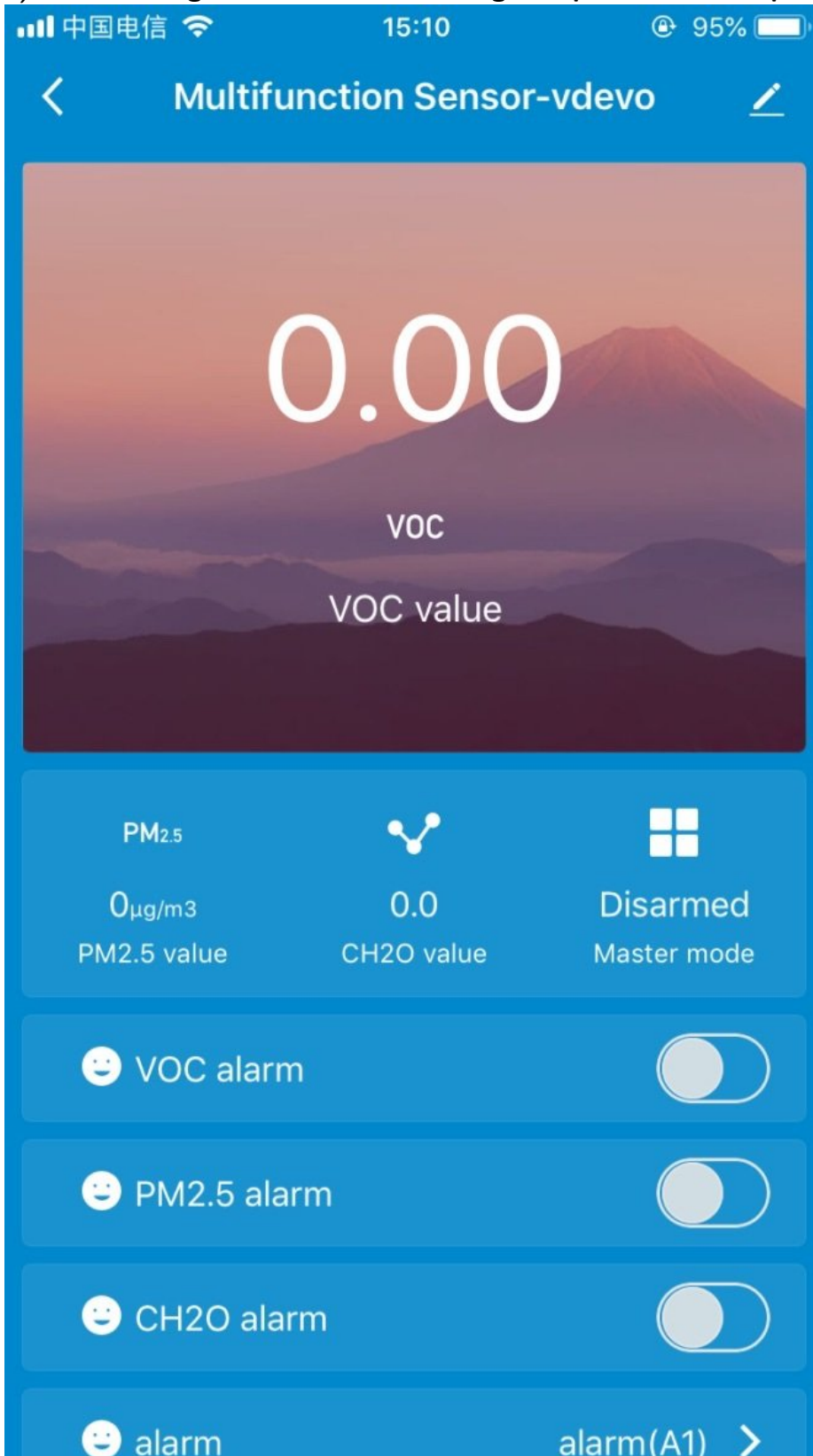

2.2.2 Set multilingual text (Clean up App cache or re-scan the code if the modification is ineffective)

You can edit the text descriptions of data points in the [Multilingual](#) menu. Since the function modules in the free configurable panel are totally composed of data points, the text of this part will be all displayed on the panel. Use multi-language text wisely to get a better panel.

Note: If a field is not filled with texts, the function point name or the key value of the language package will be displayed by default.

a) The following table shows the initial text of the Product Information

Function Number	Function points	Attribute Value	Language package key value	Chinese (Simplified)	English
31	VOC 检测值	-	dp_voc_value	VOC 检测值	VOC Value
	voc_value	unit	dp_voc_value_unit		
33	PM2.5 检测值	-	dp_pm25_value	PM2.5 检测值	PM2.5 Value
	pm25_value	unit	dp_pm25_value_unit		
39	甲醛检测值	-	dp_ch2o_value	甲醛检测值	CH2O Value
	ch2o_value	unit	dp_ch2o_value_unit		
40	布防模式	-	dp_mode_arm		
	mode_arm	armed_staying	dp_mode_arm_armed_staying		
		disarmed	dp_mode_arm_disar		
		armed_leaving	dp_mode_arm_armed_leaving		
101	VOC 告警	-	dp_bt_voc		
	bt_voc	on	dp_bt_voc_on		
		off	dp_bt_voc_off		



Function Number	Points	Attribute Value	Language package key value	Chinese (Simplified)	English
102	PM2.5 告警	-	dp_bt_pm25		
	bt_pm25	on	dp_bt_pm25_on		
		off	dp_bt_pm25_off		
103	甲醛告警	-	dp_bt_coho		
	bt_coho	on	dp_bt_coho_on		
		off	dp_bt_coho_off		
104	报警方式	-	dp_alarm		
	alarm	A1	dp_alarm_a1		
		A2	dp_alarm_a2		
		A3	dp_alarm_a3		
		A4	dp_alarm_a4		

b) Supplement the multilingual texts as follows:

Function Number	Points	Attribute Value	Language package key value	Chinese (Simplified)	English
31	VOC 检测值	-	dp_voc_value	VOC 检测值	VOC Value
	voc_value	unit	dp_voc_value_unit	mg/m ³	ppm
33	PM2.5 检测值	-	dp_pm25_value	PM2.5 检测值	PM2.5 Value
	pm25_value	unit	dp_pm25_value_unit	µg/m ³	µg/m ³
39	甲醛检测值	-	dp_ch2o_value	甲醛检测值	CH2O Value
	ch2o_value	unit	dp_ch2o_value_unit	ppm	ppm
40	布防模式	-	dp_mode_arm	模式	Model



Function Number	Points	Attribute Value	Language package key value	Chinese (Simplified)	English
		armed_staying	dp_mode_arm_armed_staying	布防	Armed
		disarmed	dp_mode_arm_disarmed	撤防	Disarmed
		armed_leaving	dp_mode_arm_armed_leaving	离家	leaving
101	VOC 告警	-	dp_bt_voc	VOC 告警	VOC alarm
	bt_voc	on	dp_bt_voc_on	开	On
		off	dp_bt_voc_off	关	Off
102	PM2.5 告警	-	dp_bt_pm25	PM2.5 告警	PM2.5 alarm
	bt_pm25	on	dp_bt_pm25_on	开	On
		off	dp_bt_pm25_off	关	Off
103	甲醛告警	-	dp_bt_coho	甲醛告警	COHO alarm
	bt_coho	on	dp_bt_coho_on	开	On
		off	dp_bt_coho_off	关	Off
104	报警方式	-	dp_alarm		
	alarm	A1	dp_alarm_a1	声音报警	Sound
		A2	dp_alarm_a2	光亮报警	Light
		A3	dp_alarm_a3	声光报警	Sound&Light
		A4	dp_alarm_a4	报警解除	Disarm



2.2.3 Adjust panel layout

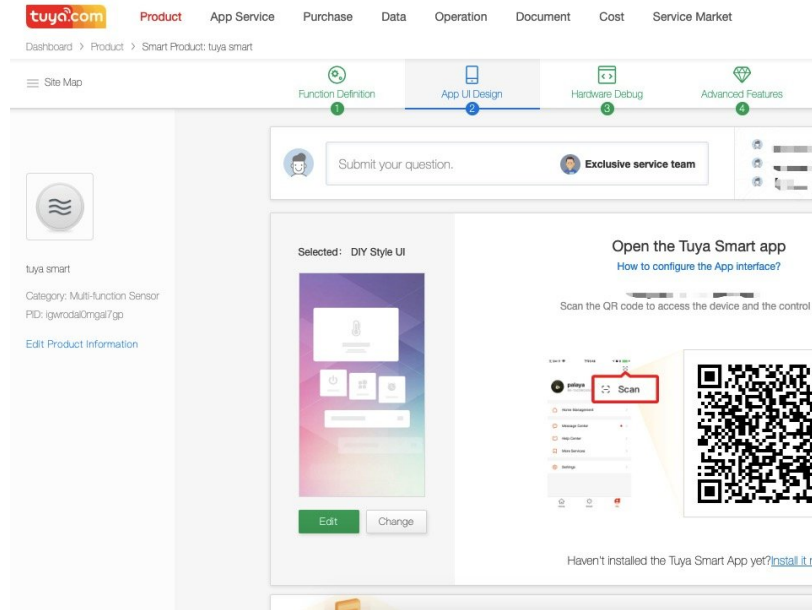

a) In the App UI Design menu, click “Edit”.

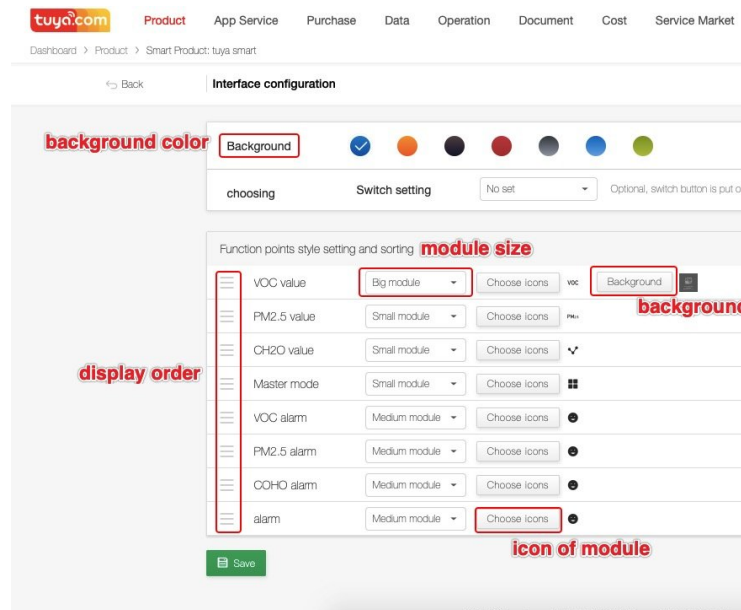

b) The initial UI are shown in the following figure.

c) You can sort icons, adjust module size, change icons, and select background. After that,

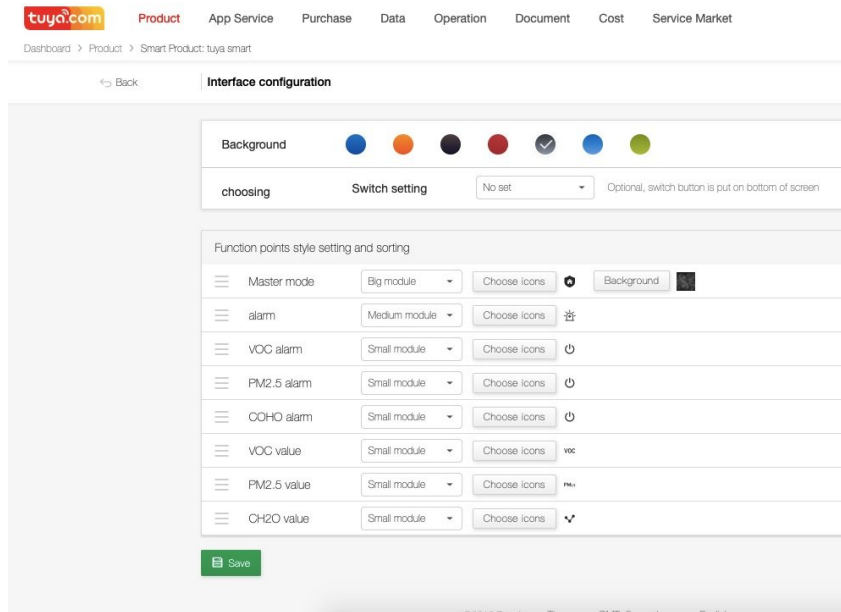

the final function point style is as follows.

d) Description of each configuration function.

- Drag and Drop

A column can display **one large module**, **one medium module**, and **three small modules**.

When two small modules are separated by a large module or a medium module, the two small modules will be independently columned and centered.

- Modify Module Size

Note:

Large modules support the use of sliders to adjust `Integer` type function points.

The medium module can display the `Boolean` type function points as a switch button.





- Change Icons

An icon will be displayed for each function point, and the icon will be displayed above the function point name.

Upload a custom icon is currently not supported.

- Background Selection

Only large modules can display background images.

Uploading a custom background image is currently not supported.



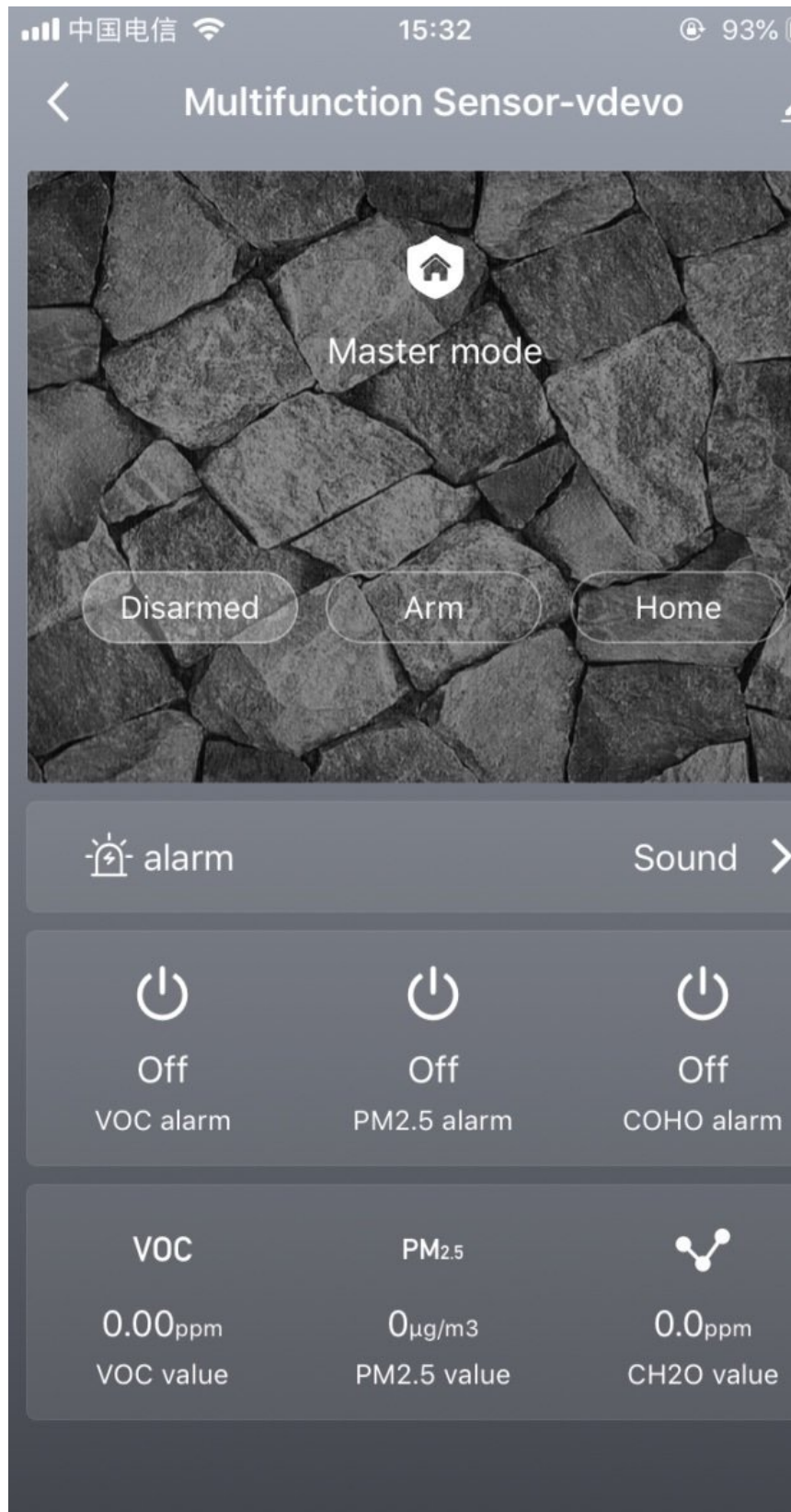

e) The final panel is shown as the figure.