



OEM App Auto Building

App Development > OEM App > OEM App Auto Building

Version: 20200518

Contents

1	Log in to the IoT platform	1
2	Create App	2
2.1	Complete App information	2
3	App Configuration	4
3.1	Personalization configuration:	4
3.2	Function Configuration	11
3.3	More Settings	12
4	Version List Page	18
4.1	modify App name	18
4.2	Configure certificates	18
4.3	QR Code to Print	20
4.4	Network Distribution	21
4.5	Configure protocols	34
4.6	Upgrade Notification:	35
4.7	Convert to SDK:	35
5	Build App	36
6	Purchase App	40
7	Launch App	44
7.1	The Service Purchased on the Value-added Services Market before Launching	44
7.2	Self-service Launch	47
7.3	Purchase Service	53
8	Subscription	57

1 Log in to the IoT platform

Log in Tuya IoT Platform <https://iot.tuya.com> , enter into the login page, you could log in directly if you have an existing account; If there is no account, please register first and then log in.

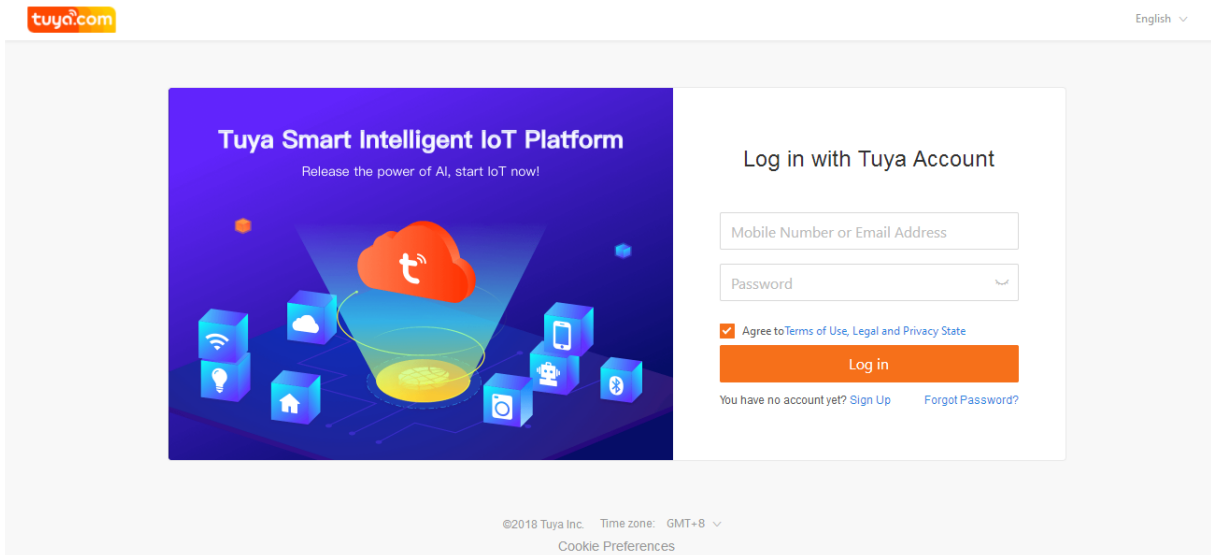

2 Create App

Enter into **[Home]** section, click **App Service**

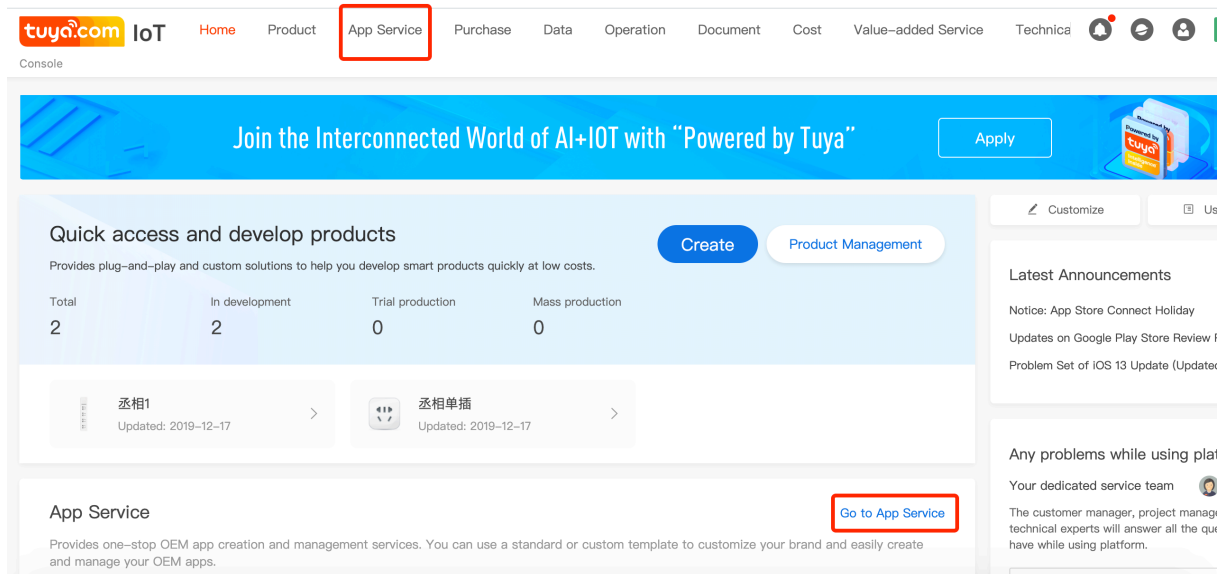

!

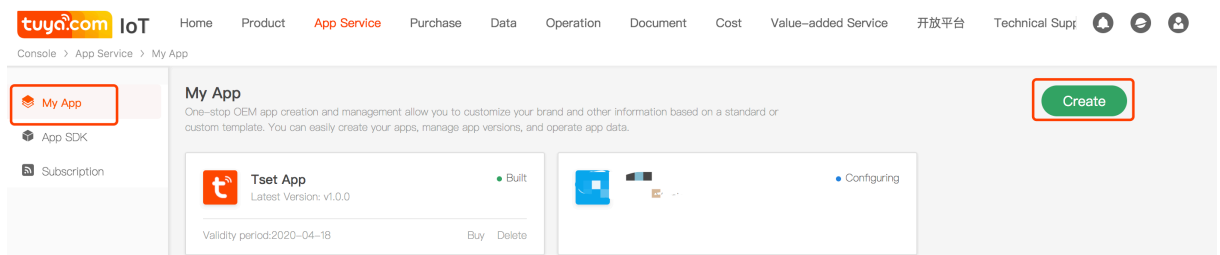

Figure 1: 1010.png

2.1 Complete App information

- **App Name:** It is recommended to input the length within 6 Chinese characters or 12 English letters as the App name which is displayed on the mobile phone desktop. This name will appear on the phone’s home screen.
- **Android package name:** As the unique identifier of the App, it is not allowed to be duplicated. It is recommended that each segment is controlled within 3-20 letters, Characters, numbers,underscores are available, please use “.” to separate for at least two segments and each section begin with characters.Not contain “tuya” information.

- **iOS package name:** As the unique identifier of the App, it is not allowed to be duplicated. It is recommended that each segment is controlled within 3-20 letters, Characters, numbers, line-through are available, please use "." to separate for at least two segments and each section begin with characters. Not contain "tuya" information.

This name will appear on the phone's home screen.

Create App X

? *Name : Please input the name of application

? *Android Package Name : Recommended format: com.xxx.xxx.

? *iOS Package Name : Recommended format: com.xxx.xxx.

Cancel Ok

Figure 2: 包名.png

3 App Configuration

3.1 Personalization configuration:

It determines the appearance of your App: including App icon, App startup page, App color theme.

- **App icon:** It only supports png format, the size should be equal to 1024 * 1024px;

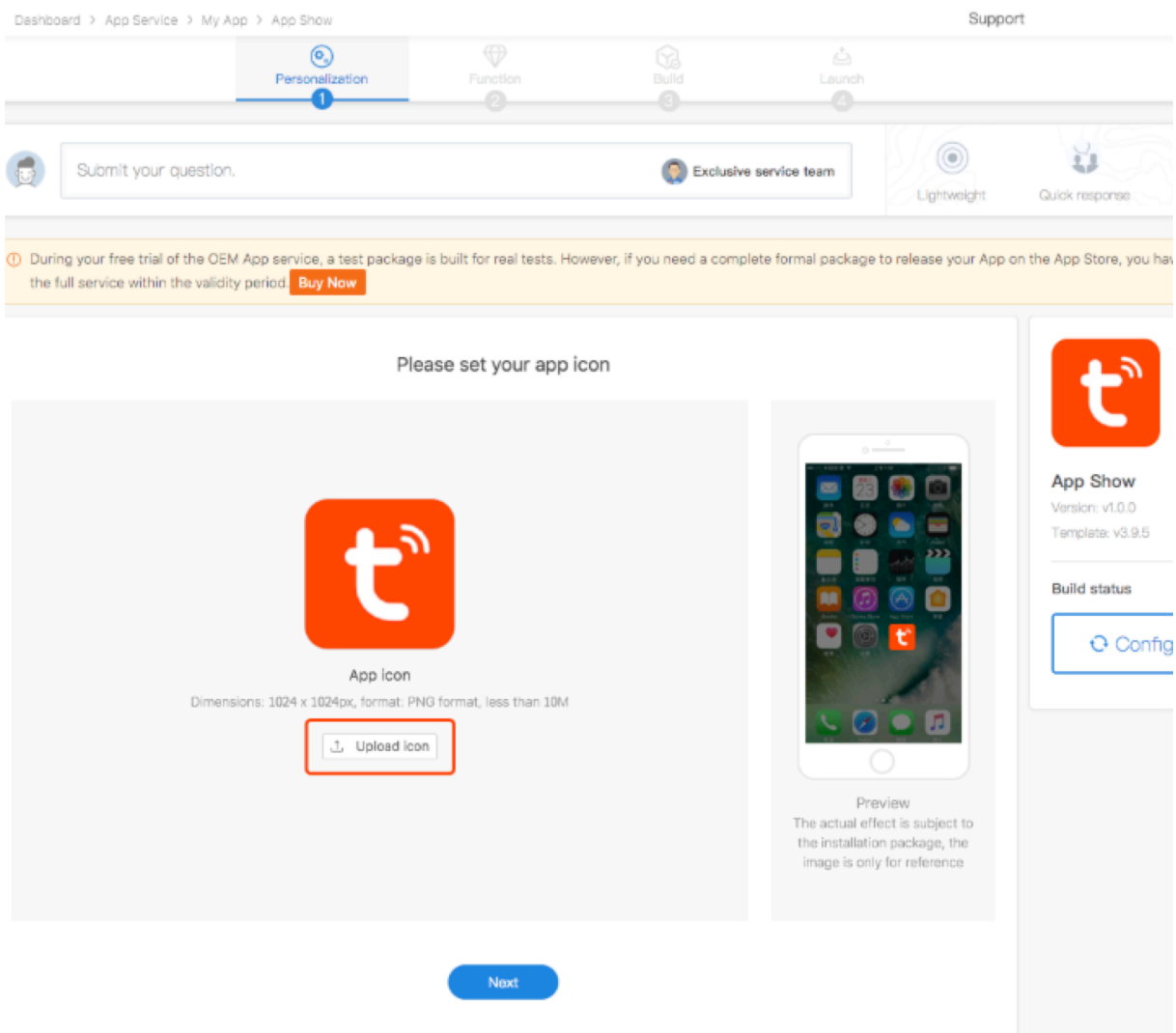

Figure 3: 4.png

- **App startup page:** After uploading the logo, the system will automatically

generate a startup page for you. If you are not satisfied with it, you also can re-upload it; It only supports png format, you can choose to **click once to upload** (1242*2688px), or upload separately in a single size;

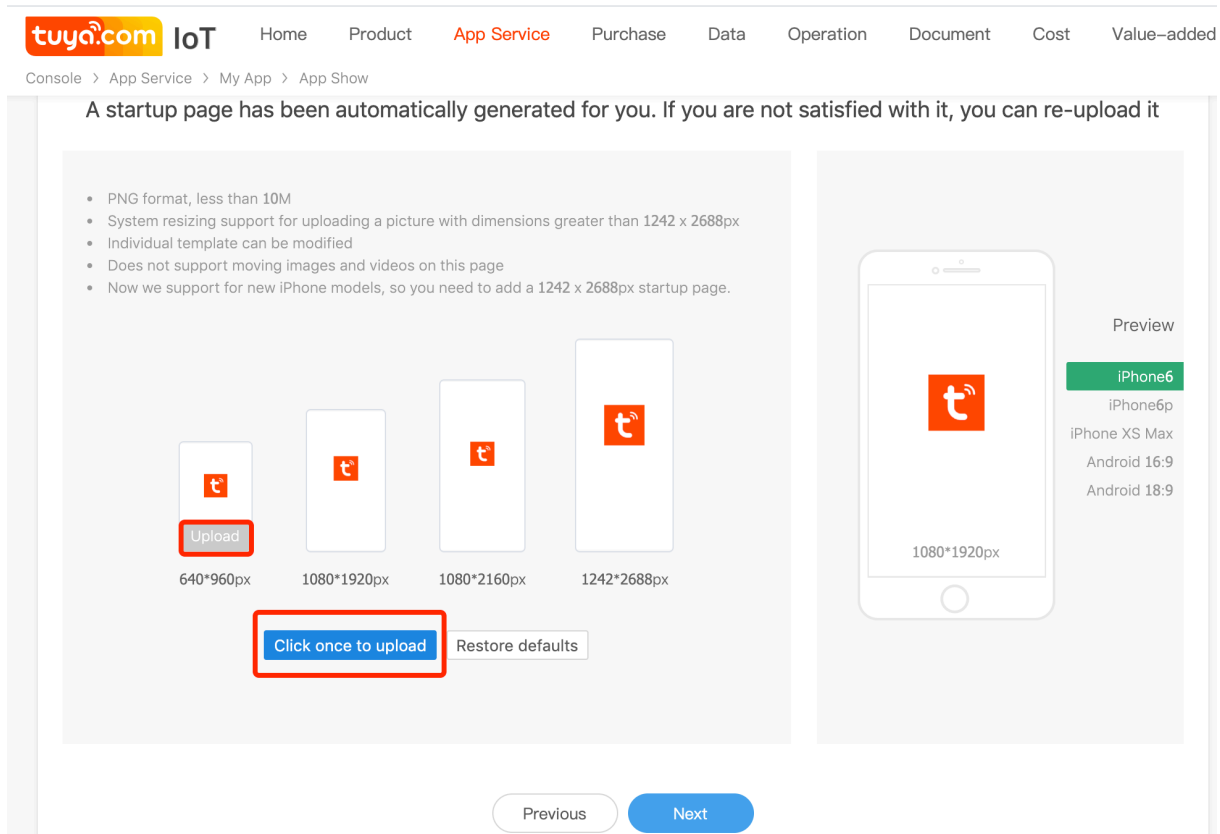

Figure 4: 6.png

- **App color theme:** Including setting the navigation font color at the bottom of the App, prompting background color, prompting font color, etc., preset 21 color schemes for quick selection, and support custom setting colors;

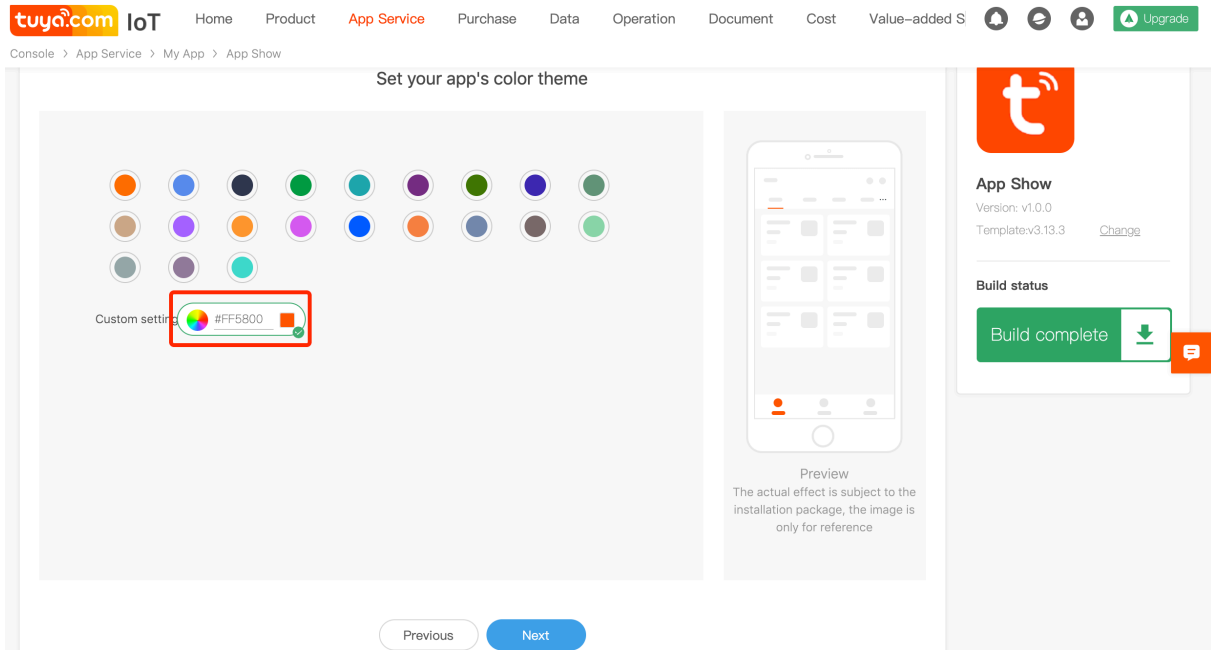

Figure 5: 7.png

Please confirm the App Personalization custom effect after configuration. If you are not satisfied, click the 'Re-upload' button to modify

Dashboard > App Service > My App > App Test Support

Personalization **1** Function **2** Build **3** Launch **4**

Submit your question. Exclusive service team

Lightweight

ⓘ During your free trial of the OEM App service, a test package is built for real tests. However, if you need a complete formal package to release your App to the full service within the validity period, [Buy Now](#)

App configuration effects

App icon	App startup image	App color theme
<input type="button" value="Re-upload"/>	<input type="button" value="Re-upload"/>	<input type="button" value="Reset"/>

You can also define the following two items

App Tab icon settings <input type="button" value="Set up"/> The App Icon you've set up will be shown on mobile phones	Login and Registration page background image, Login and Registration page logo <input type="button" value="Reset"/> The App icon you've set up will be shown on mobile phones
--	--

Figure 6: 8.png

Note: If you want to quickly demo demo, after the above configuration is confirmed, you can continue to click **Next**. If the basic function configuration is not modified, the graffiti provides default configuration. After submitting **Immediately build**, refer to the sixth step of this manual. Can be tested first.

- **App Tab icon Settings:** Tuya provides the default Tab icon. If you need to modify it, you can click **Settings** to replace it.

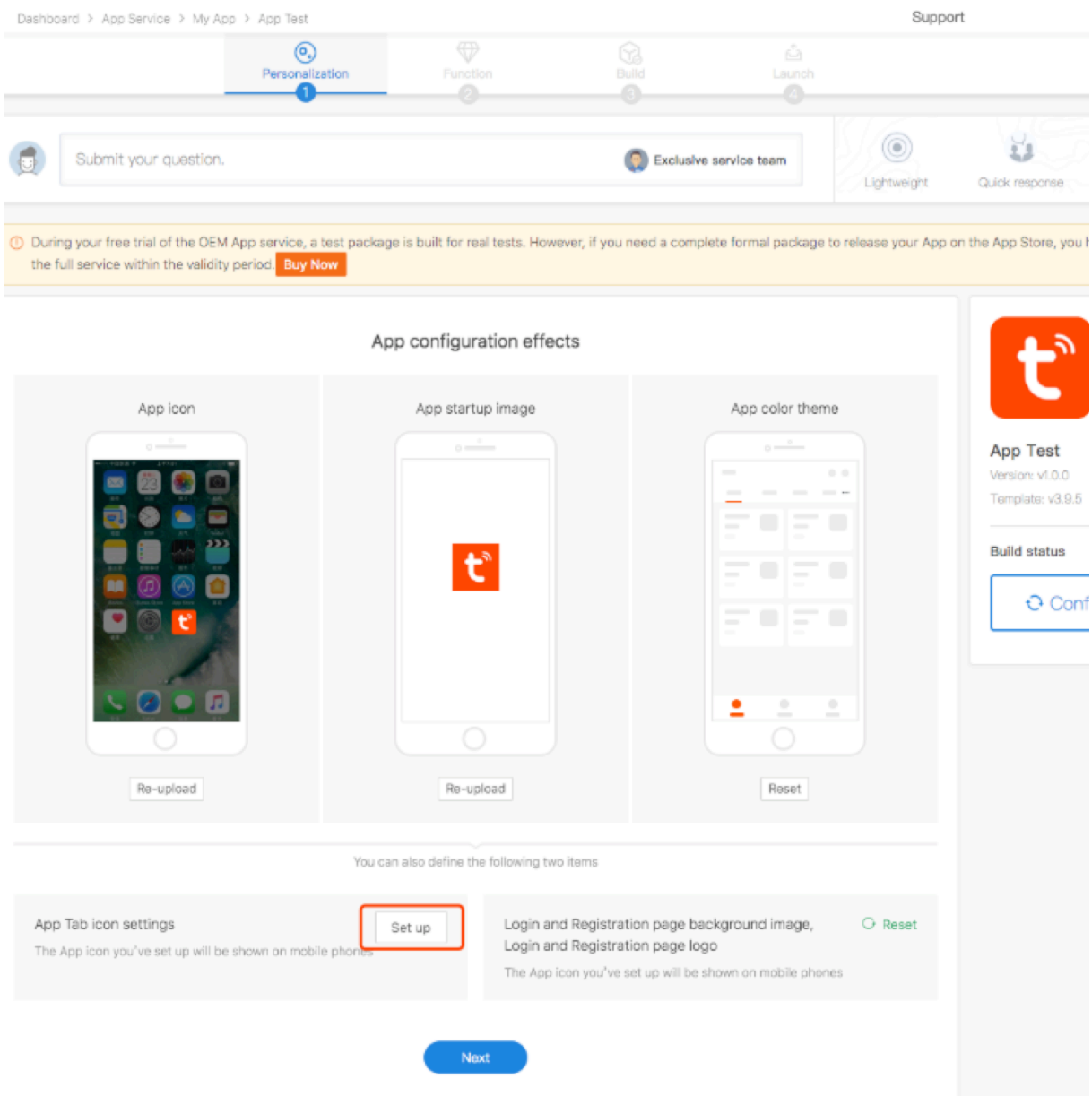

Figure 7: 9.png

Note: You can upload 6 icons of your own design here, the size must be 108 * 108px, PNG format. The red box below shows: **Default** means icon is not selected, **Activate** means icon is selected;

The effect can be seen in real time in the mobile phone model on the right; the font color of the copy also supports customization;

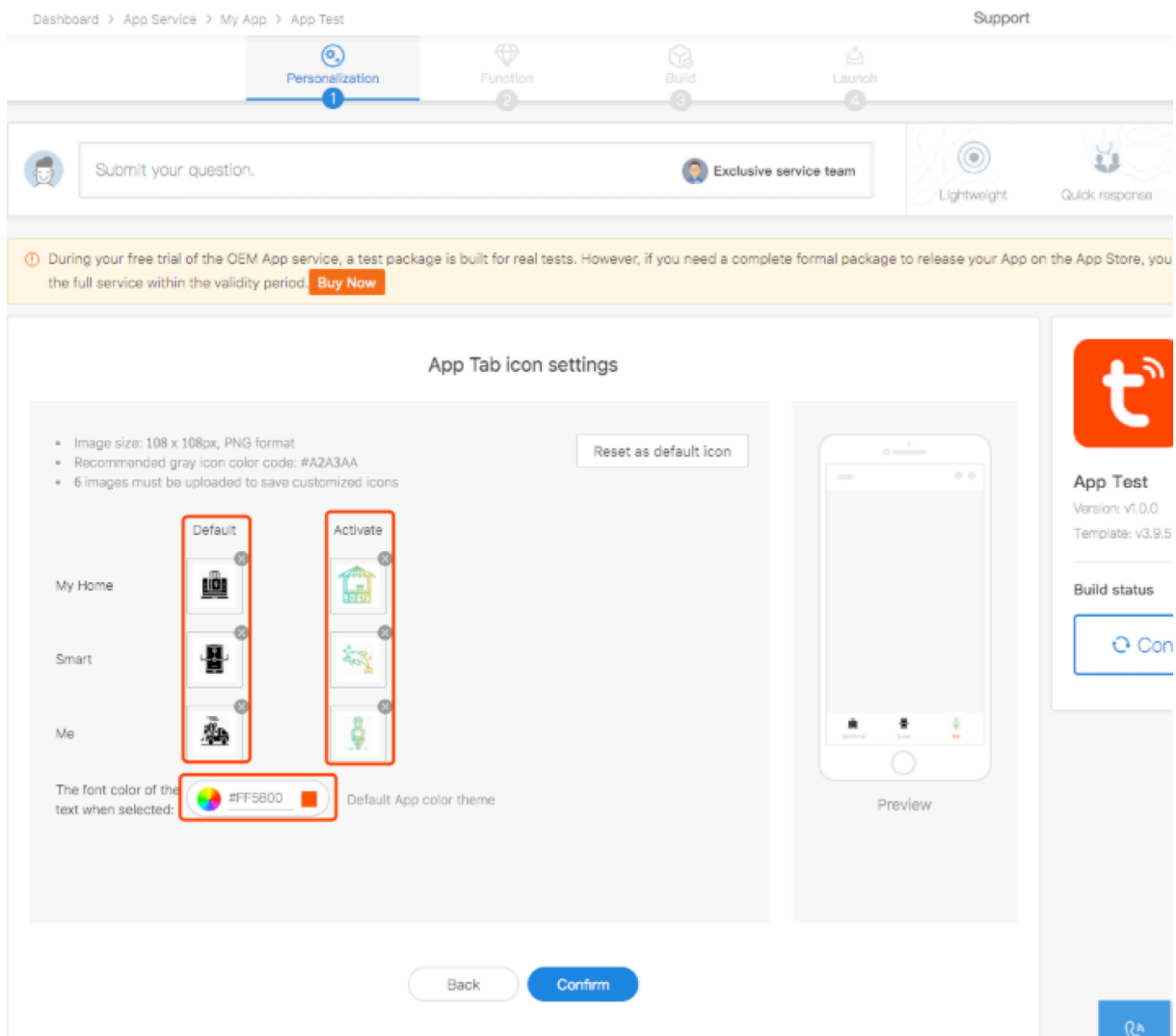

Figure 8: 10.png

- **Login and Registration page background image, Login and Registration page logo** Tuya provides the default Tab icon, if you need to modify, you can click **to set** to replace;

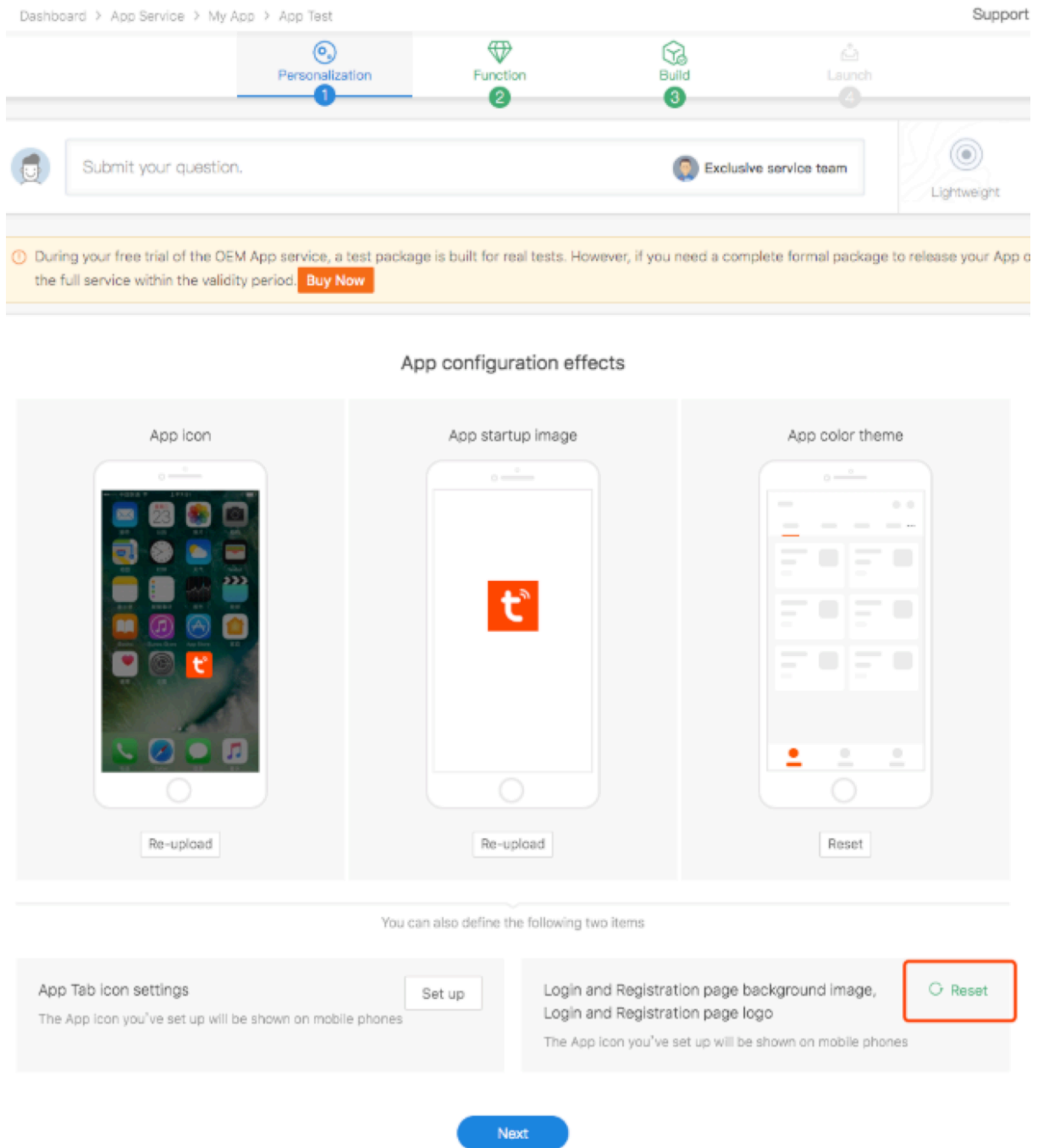

Figure 9: 11.png

- **Sign in/sign up background:** Support format: png, image size: 1080 * 1920px (recommended replacement)

- **Sign in/sign up logo:** Supported format: png, logo size: 400 * 400px

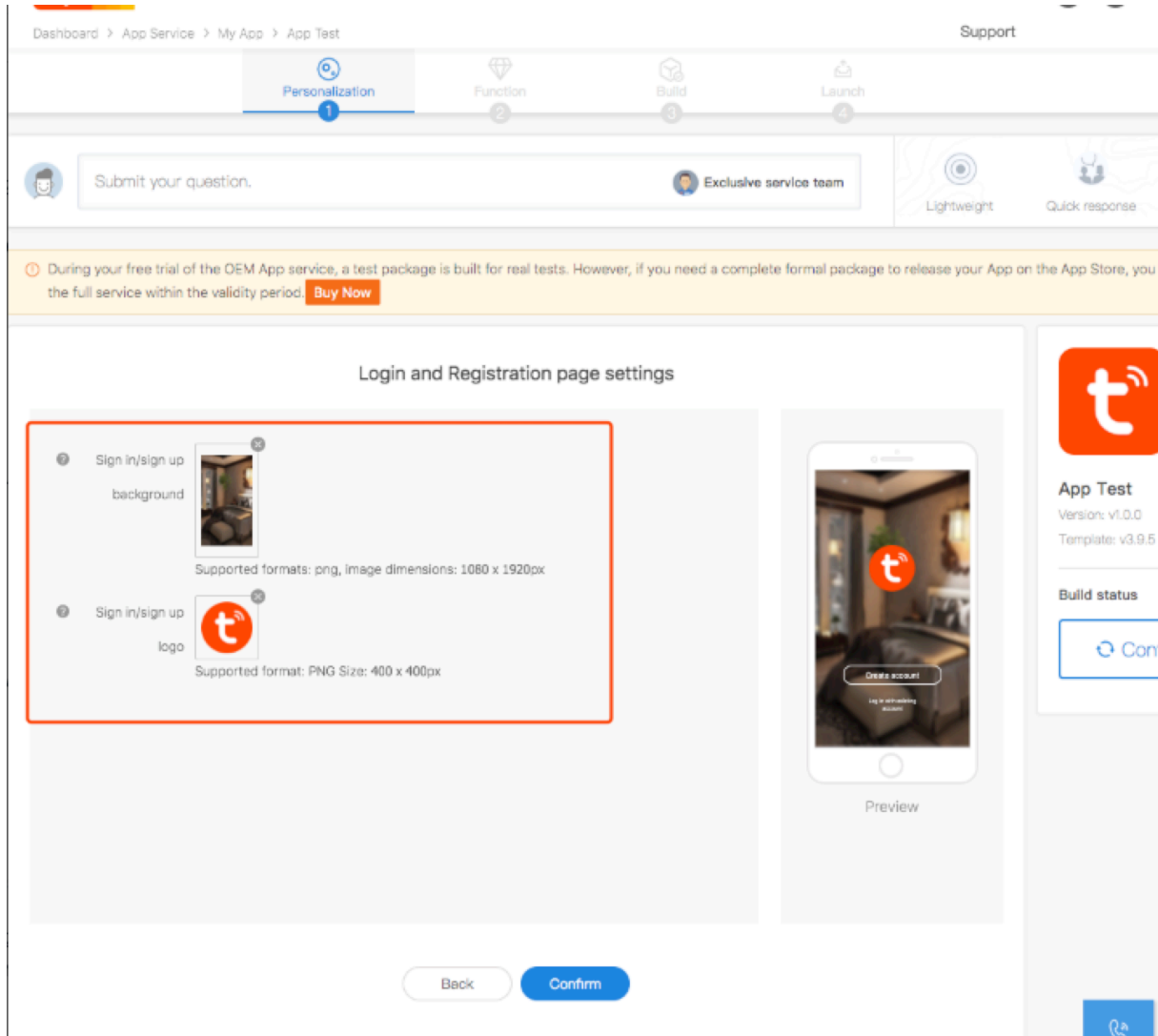

Figure 10: 12.png

3.2 Function Configuration

Map positioning: Click **Get SHA1** to get App related value, and check **help**, then you could configure the Map Key according to the operation guidance manual, and obtain the corresponding key and fill it into the box. **(If you want to process for the App store, it is the mandatory item)**

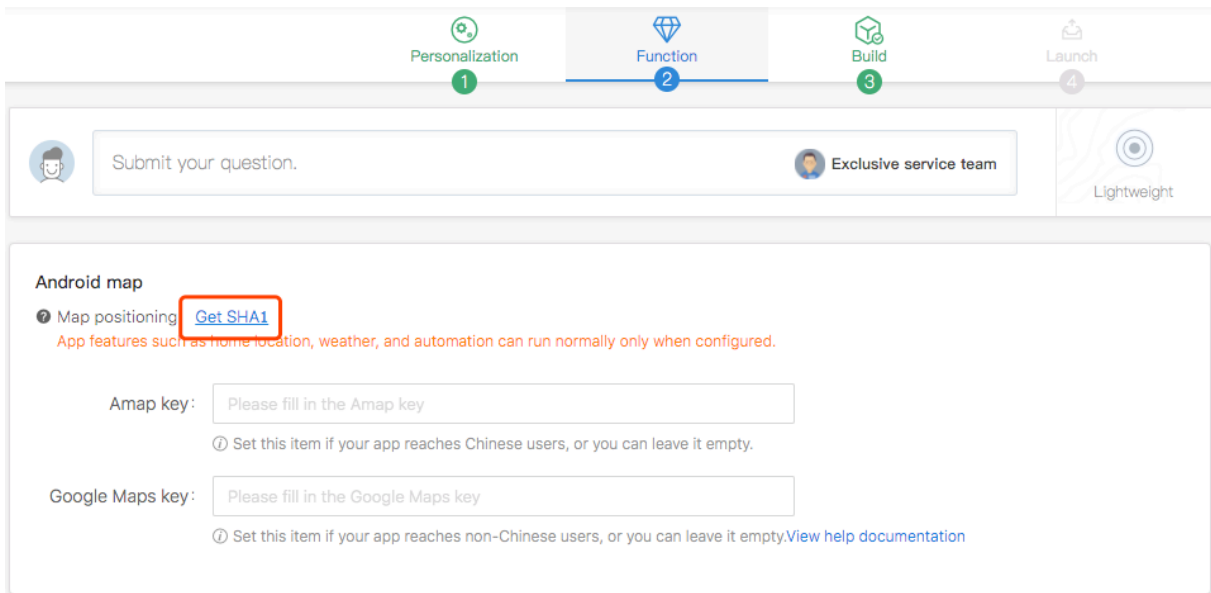
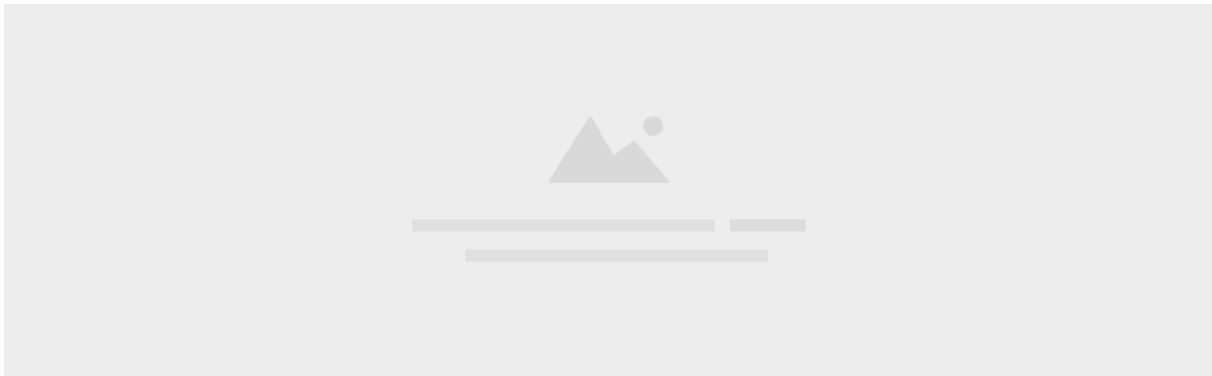

Figure 11: 88.png

3.3 More Settings

At present, there are **Multi-language settings**、**Expansion settings**、**Third-party support**、**Mail Function Configuration** in this section.



Multi-language settings: Multi-language setting can be configured for part of the App language.(If you want to modify, please contact the Tuya staff.)

Expansion settings : The right mobile phone model can preview the configuration effect in real time,, please select it according to your actual requirements.

Copyright information:

About us:

FAQ & Feedback: [Click to go to create your private library](#)

Privacy Policy: Supported Not supported

User Agreement: Supported Not supported

Supports Bluetooth: Supported Not supported

Smart scenarios: Supported Not supported

Scan: Supported Not supported

Gesture password: Supported Not supported

Dashboard weather: Supported Not supported

Simultaneous log ins on multiple devices: Supported Not supported

Upload an empty list page:

Supported formats: png, image size: 180*180px

Default avatar: 

Supported formats: png, image size: 144*144px

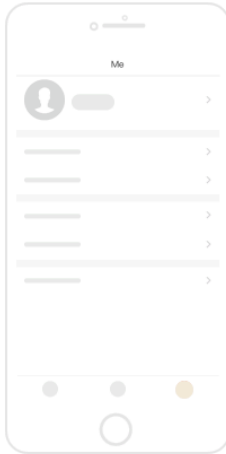
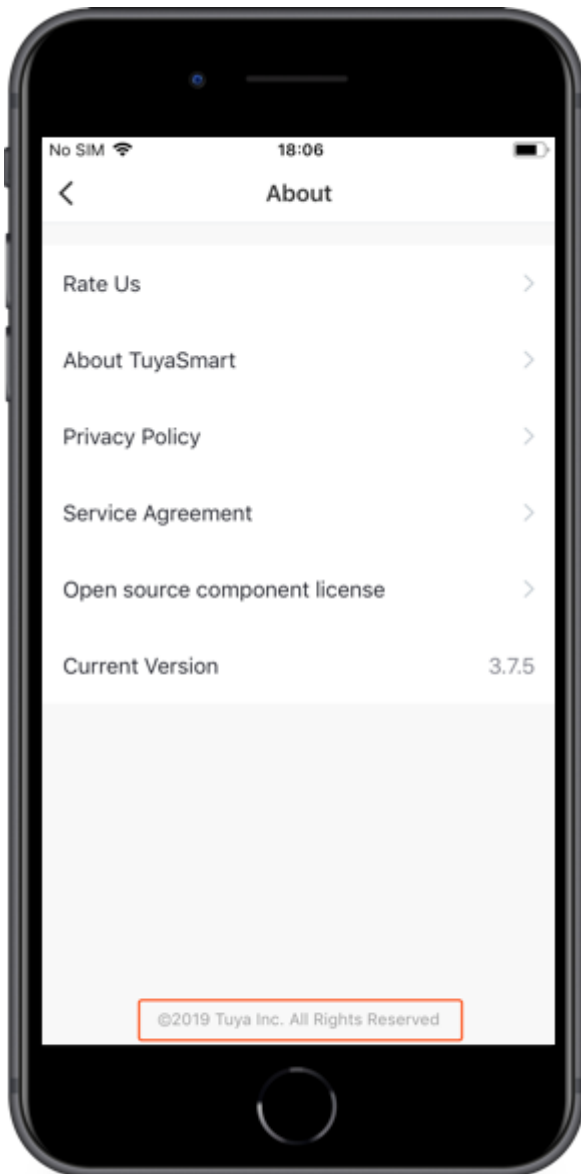

Figure 12: 12345678.png

- **Copyright information:** You can add the copyright information of the App at the bottom of the “Me - Settings - About” page on the mobile side.

Please refer to the following picture for the App page displays, and take Official template A V3.12.1 as an example



- **About us:** Please fill your website link in [About us](#) starting with https:// or http://
- **FAQ & Feedback:** You can use Tuya's default FAQ or click to go to create your private library
- **Privacy Policy:** You can choose whether it supports the Privacy Policy to your actual needs
- **User Agreement:** You can choose whether it supports the User Agreement to your actual needs
- **Support Bluetooth:** You can choose whether it supports Bluetooth device

distribution network according to your actual needs.

- **Smart scenarios:** You can choose whether it supports the smart scene function according to your actual needs.
- **Scan:** You can choose whether it supports this function according to your actual needs.
- **Gesture password:** You can configure whether to enable the App's gesture password function. If enabled, the user of the App can use the gesture password to lock/unlock the App to improve the security.
- **Dashboard weather:** You can choose whether it supports this function according to your actual needs.
- **Simultaneous log ins on multiple devices:** According to your actual needs, you can choose whether it supports multiple mobile phones login for the same account.
- **Upload an empty list page:** You can configure the bottom picture when all the lists in the App are empty.
- **Default avatar:** You can configure the default avatar of the personal center within the App.

Third-party support : (If you need to enable it, please check it first ,then refer to the help documentation for configuration.)

- **Third-party voice support:** If your product is connected to a smart speaker, you could check the corresponding speaker skill here, and please fill in the skill name on the right side, after checking, it would have the corresponding button in the App- personal center-more services. Then click the button to jump to the voice assistant accessing help page. If want to modify the content of the help page, please consult the Tuya staff.

Note: If your OEM App needs to use Alexa and Google Assistant, you need a separate OEM skill. In addition, Alexa has implemented an Alexa App-to-App account link,you can view the **Service introduction** or **Subscribe** the service if you need it.

Third-party voice support

If your product is support a smart speaker, you can check it and open the corresponding help document entry in the personal center.

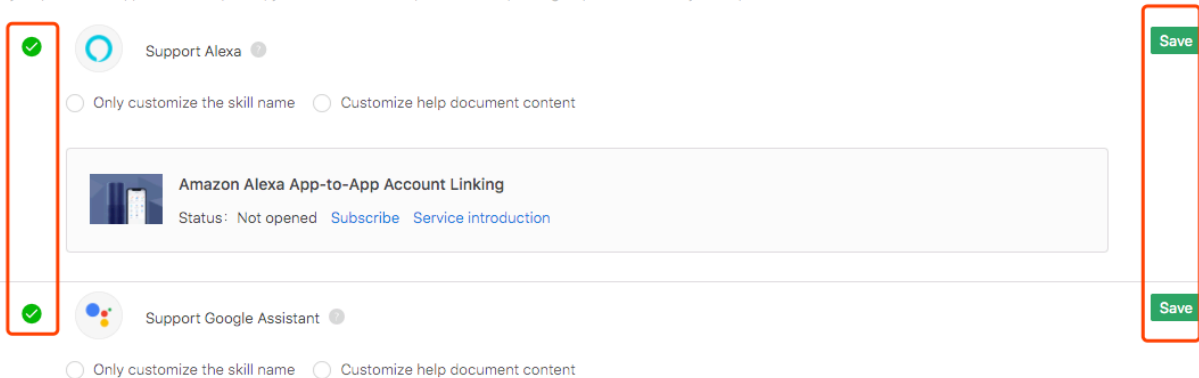

Figure 13: 英文.png

- **Third-party login support : App Store requires that Apple login be enabled for apps for which third-party login has been enabled.**

Domestic Support QQ and Wechat, abroad support Facebook, please select it according to your actual demand. Accessing the Facebook has the active the lower limitation. If it doesn't reach the lowest bound, it would be canceled the authorization, also it would fail to use the third-party Facebook to sign on in the App. More detail rules please reference the Facebook document.

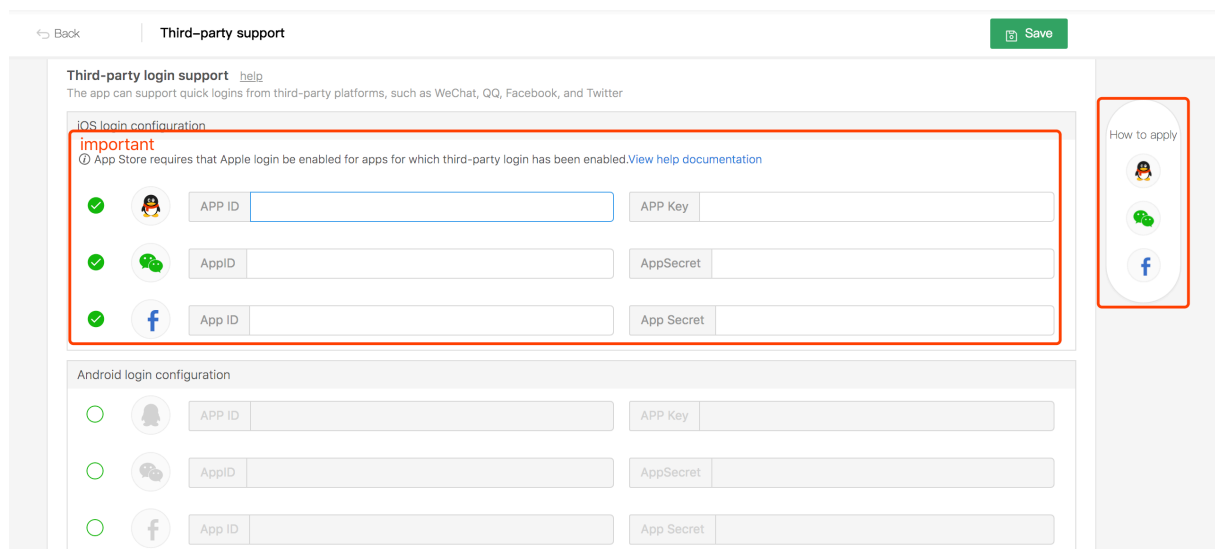

Figure 14: 77.png

Mail Function Configuration : If you need to activate, please purchase first, and

refer to it after completing the payment: [OEM App Mall Operating Instructions Document](#)

4 Version List Page

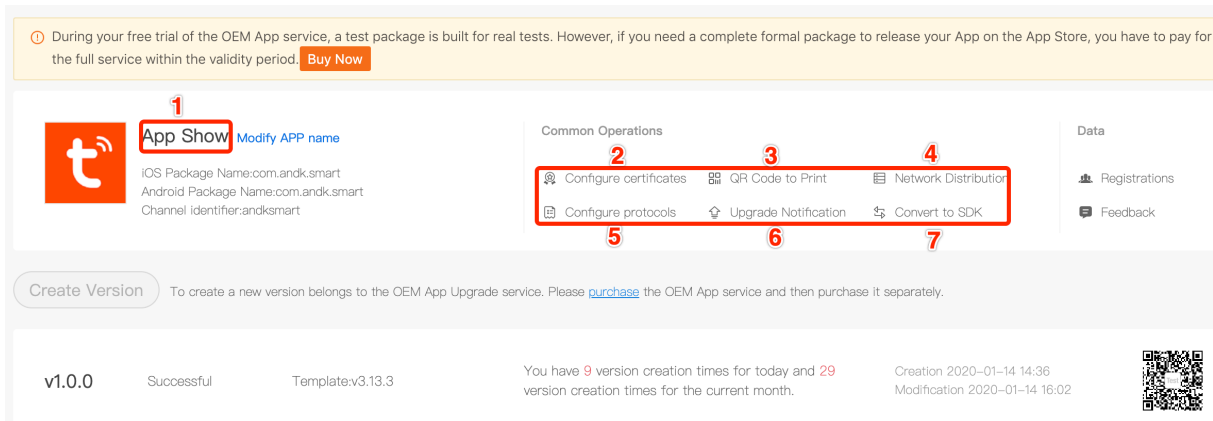

Figure 15: 19.png

4.1 modify App name

Support for modifying the App name. After modification, it needs to be rebuilt to take effect.

4.2 Configure certificates

If the application needs to be published to the application store, the relevant certificate needs to be uploaded here. Please register the developer account first, **please refer to the document**, if the certificate is not uploaded, the system will not be able to build an official ipa file and cannot publish the store.

- Generate the certificates automatically (**Recommended**): This function is an auxiliary function. Because the certificate generation process is more complicated, you can try to generate all certificates with one click and upload them automatically. This function just fill in the authorization information and complete the certificate configuration in 1 minute.

← Back | Configure certificates

iOS Certificate | Android Certificate

iOS Certificates Management

Generate the certificates automatically Recommended
Just fill in the authorization information and complete the certificate configuration in 1 minute

Self-generated certificates and uploading them on IoT platform
The app certificate and push certificate have to be generated on the Apple Developer Platform and be uploaded on IoT Platform, which is complicated and time-consuming

Generate the certificates automatically

* Apple ID: [Create Apple ID](#)

* App-specific passwords: [How to manage app-specific passwords?](#)

* Team Name: [What is Team Name?](#)

[Generate the certificates automatically](#)

Figure 16: 自动生成英文.png

- Self-generated certificates and uploading them on IoT platform: If **Generate the certificates automatically** fails, you can also choose **Self-generated certificates and uploading them on IoT platform**, please refer to **help Document**.

← Back | Configure certificates

iOS Certificate | Android Certificate

iOS Certificates Management

Generate the certificates automatically Recommended
 Just fill in the authorization information and complete the certificate configuration in 1 minute

Self-generated certificates and uploading them on IoT platform
 The app certificate and push certificate have to be generated on the Apple Developer Platform and be uploaded on IoT Platform, which is complicated and time-consuming

iOS Certificate

The iOS App certificate is the document that requires a signature for the App to be released on the App Store. You must apply for this certificate with a developer account on t Apple Developer website. [Click to view help documentation](#)

Mobileprovision certificate: Format:mobileprovision

p12 certificate: Format:p12

Certificate password:

iOS Push (APNS)

APNS is the abbreviation of Push Service for iOS App. Update push certificate without rebuilding the app. [Click to view help documentation](#)

Certificate file(.p12)-Production: Format:p12

Note: Please make sure to upload the Push certificate. This certificate is not the same file as the p12 uploaded in the application certificate.

Certificate password:

Figure 17: 手动制作英文.png

4.3 QR Code to Print

This QR code can be printed on the product outer packaging. The later version update of the App will not affect the normal use of the QR code. **However, you must configure a download address to display the QR code, this link is available in the App market**

APP Downloading Address Configuration

After the user scan code, the system automatically based on the user's phone system and a network environment, the download address to jump to the corresponding

iOS App Downloading Address: [Releasing iOS App help documentation](#)

Android App Downloading Address For domestic users in China:

Android App Downloading Address For Overseas Users: [Google Play Publishing help documentation](#)

Preview QR Code

Please use iPhone or Android phone to scan the code to verify whether the app can be downloaded.If there is a problem, you can check the download address.

QR Code Address:
<https://smartapp.tuya.com/andksmart>



Add App Icon

JPG bitmap format

Figure 18: 20.png

4.4 Network Distribution

At present, the page can be selected for Standard category. The general distribution network logic of Tuya is used. The Standard category does not support the modification of the relevant pages and contents of the distribution network.

Network distribution device list ?

If you choose to configure the standard category, you will use Tuya's general distribution network logic; If the product has its own distribution method, please select "Custom category" to configure the corresponding distribution mode for each product.

Please select a category:

- Standard category ?
 Custom category(Level 1 Catalog Mode)
 Custom category(Level 2 Catalog Mode)

	No.	Category icon	Category name	Distribution network
<ul style="list-style-type: none"> Electrical Smart Lighting Home Appliances I Home Appliances II Kitchen Security & Sensor Sport & Health Others 	1		Electrical Outlet	View
	2		Electrical Outlet(Bluetooth)	View
	3		Electrical Outlet	View
	4		plug (Sub)	View
	5		Multiple Socket	View
	6		Wall Switch	View
	7		Wall Switch(Bluetooth)	View
	8		Wall Switch	View
	9		Curtain Switch	View

App page display please refers to the following picture, taking Official template A V3.12.1 as an example (click "+" devices)

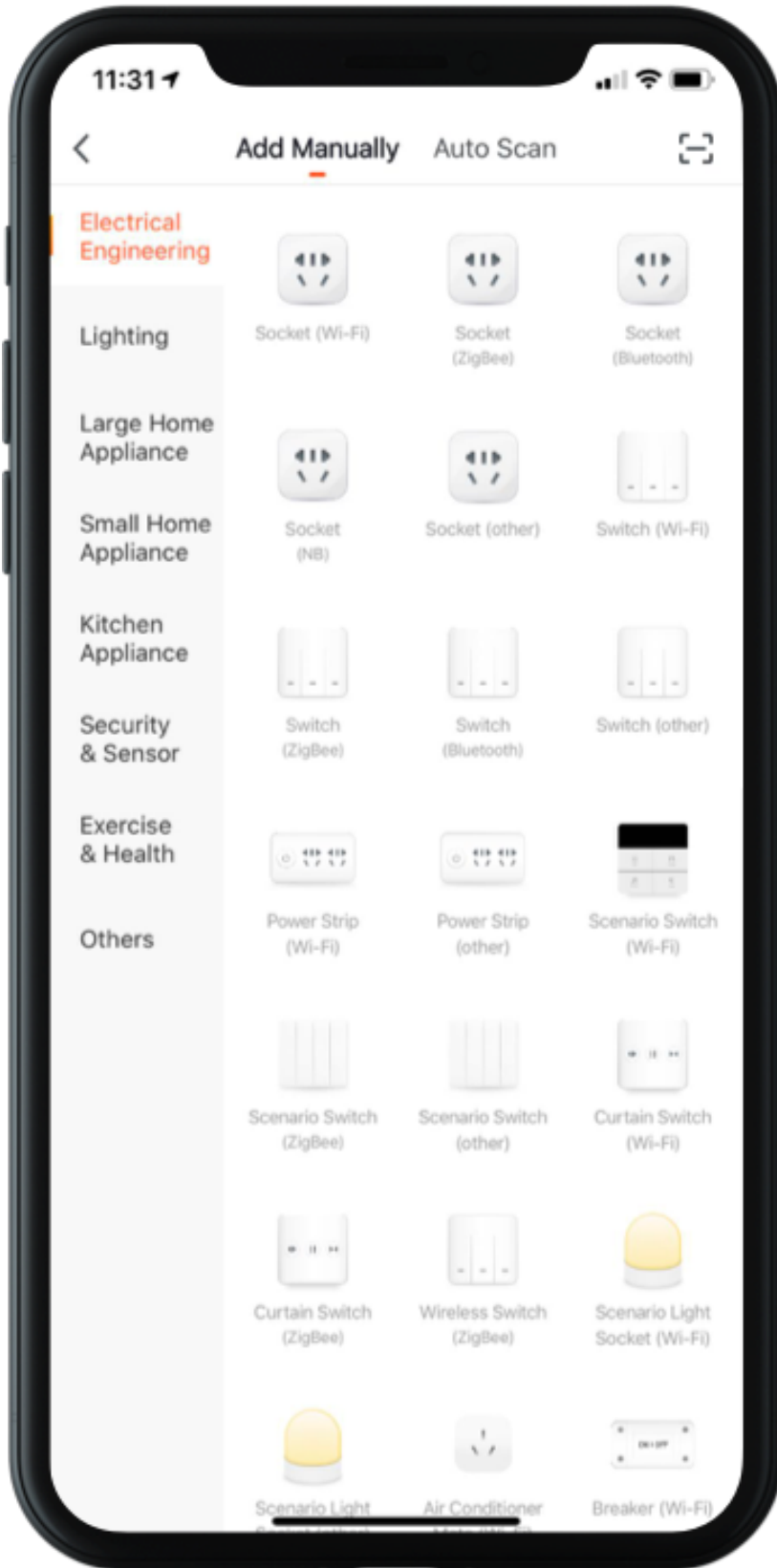

- If your actual category does not need so much, you can choose **Custom category(Level 2 Catalog Mode) - Create a standard category**, select some of the categories you need based on the public version, and select the public version which is not supported to modify the relevant page and content;

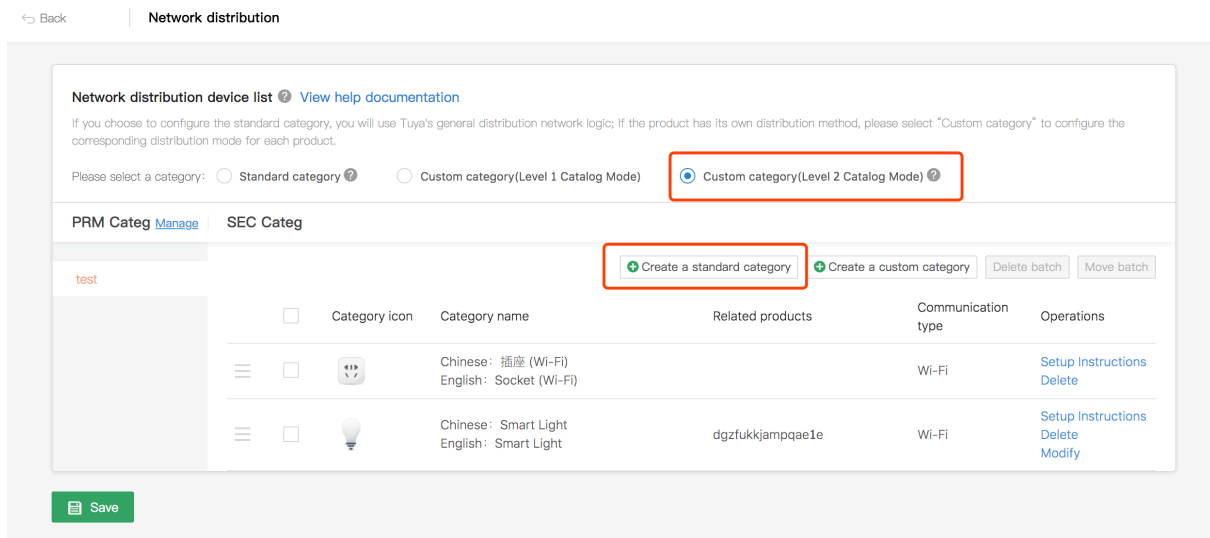

Figure 19: 标准.png

If your product has its own distribution method, you can choose **Custom category - Create a custom category** to configure, **each product supports the custom icon, name and corresponding distribution guide

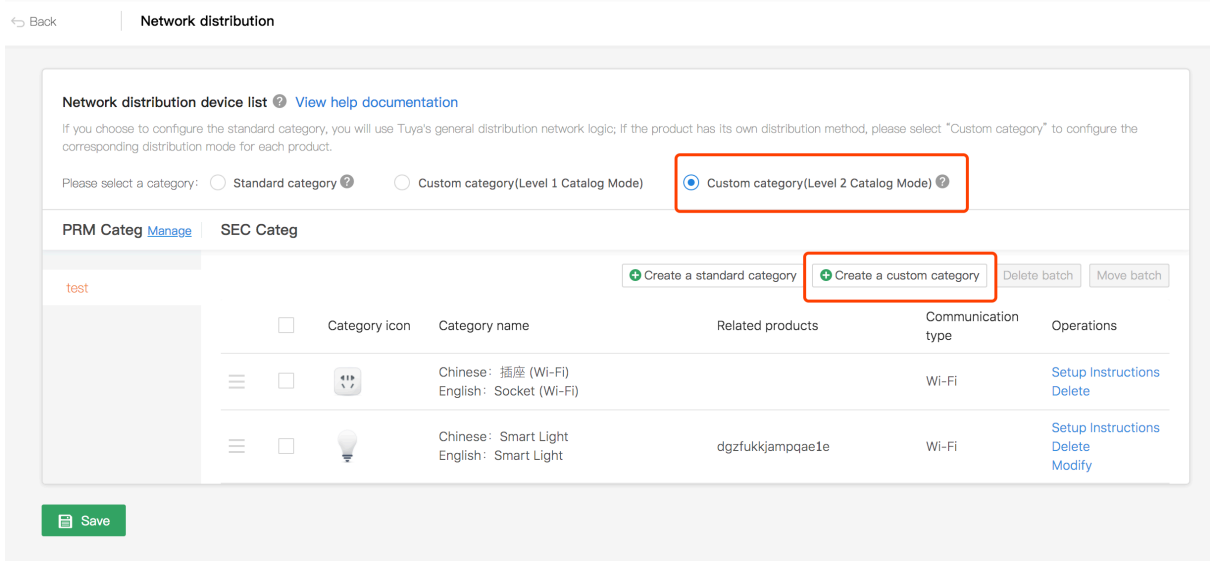

Figure 20: 自定义.png

Custom category operations are as follows

(1)Click **Create a custom category**, and the page jumps as follows. Here you need to create a custom product before you can select it in the drop-down box in **Associated Products**;

Custom distribution network category

* Related products:

* Set category icon: Dimensions limited to 240px x 240px, only supports png format

* name (Chinese):

* name (English):

Description: The Chinese copy of the app is displayed in the Chinese context, and the English copy is displayed in the English context. If no other language is set, the English copy is displayed by default.

(2)If you have not created a custom product, please go back to the **Product** page, click on **Create** to create the product you need, and then go back to the App Create a custom category to select the product;

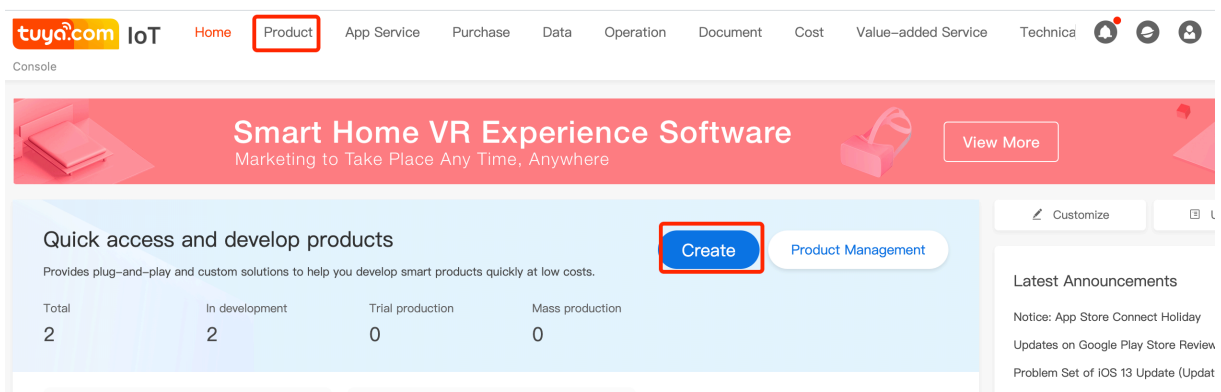

Figure 21: 13.png

(3)Only the products with Custom category support the modification. As shown in

the figure below, you can click the **Modify** button to modify the product icon and name.

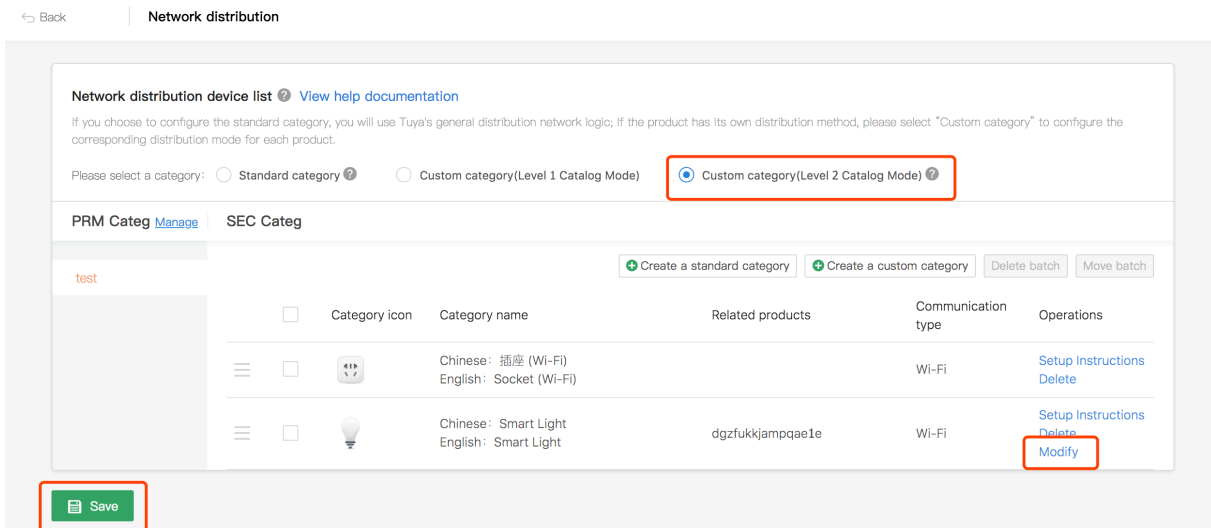

Figure 22: 修改.png

(4) You can click the **Setup Instructions** button to modify the distribution network related guide page;

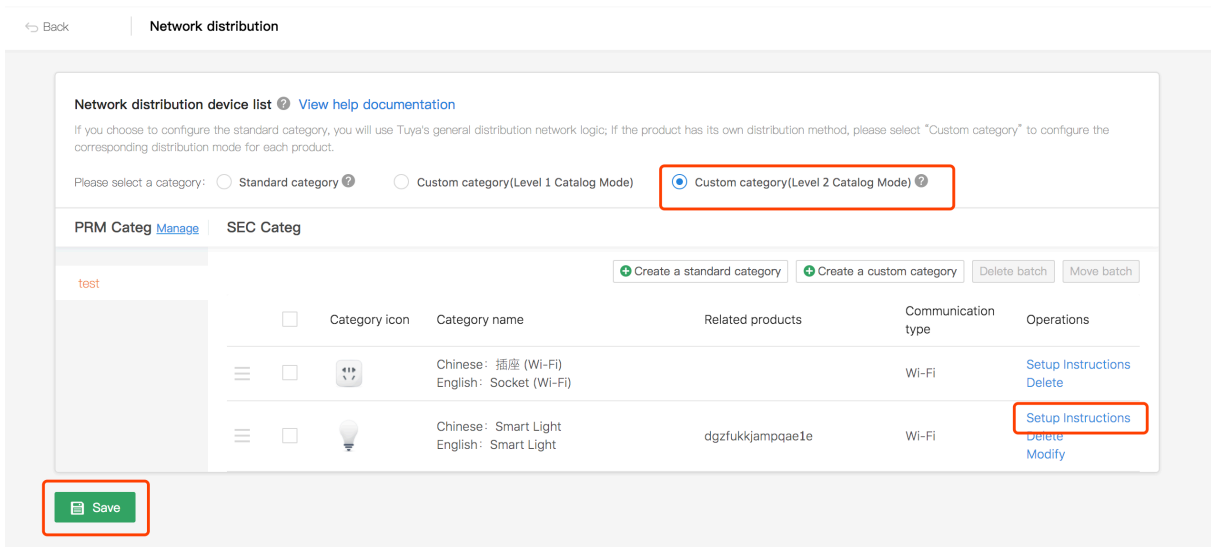

Figure 23: H5.png

(5) As shown in the figure below, there are two distribution modes: **ez linkmode (ie fast distribution mode)** and **ap linkmode (ie compatibility mode)**; the

relevant copy can be modified;

← Back
Network Connections Guides

ez linkmode

ap linkmode

Custom mode

Network connection instructions:

* Simplified Chinese:

接通电源, 确认灯在快闪

* English:

Power on the light and confirm that light blinks rapidly

Network connection guide icon:

Recommended size: 800px * 600px. Supports png/gif. Must not exceed 1 mb.

Button text:

* Simplified Chinese:

确认灯在快闪

* English:

Confirm light blinks rapidly

Title of help article:

Simplified

Chinese:

View help links

English:

View help links

More languages >

Note: In the App, Chinese text is displayed in Chinese context, and English text is displayed in English Context. English text is displayed by default if other languages are not set.

400 Cal

Figure 24: 14.png

App page display please refers to the following picture, taking Official template A V3.12.1 as an example

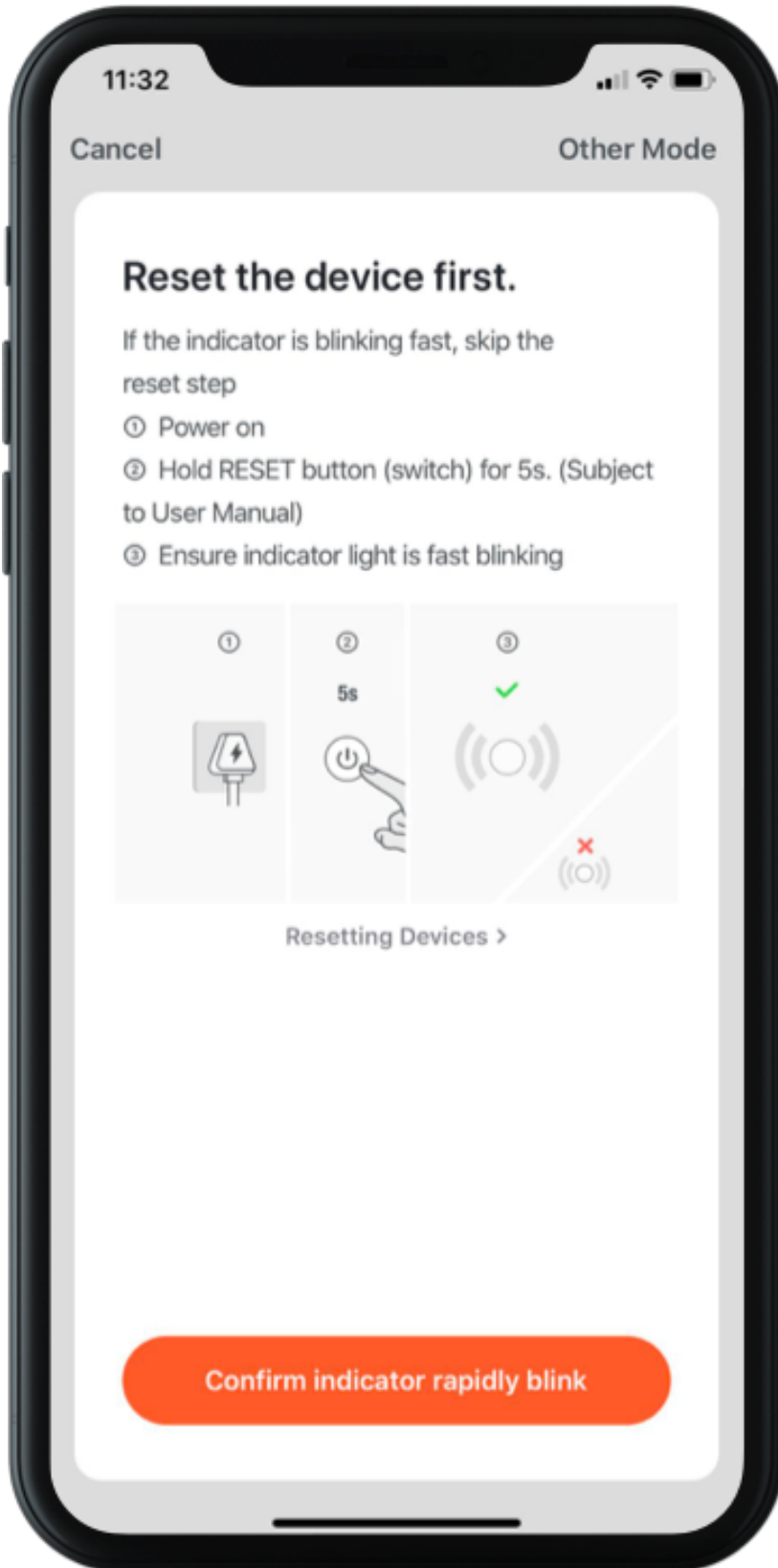

(6) As shown in the figure below, you can click the **SetUp** button to modify the distribution mode page. The file is downloaded in HTML format and need to be modified by the editor. It can be modified according to the template. Please submit the modified HTML file to the Tuya staff for uploaded ;

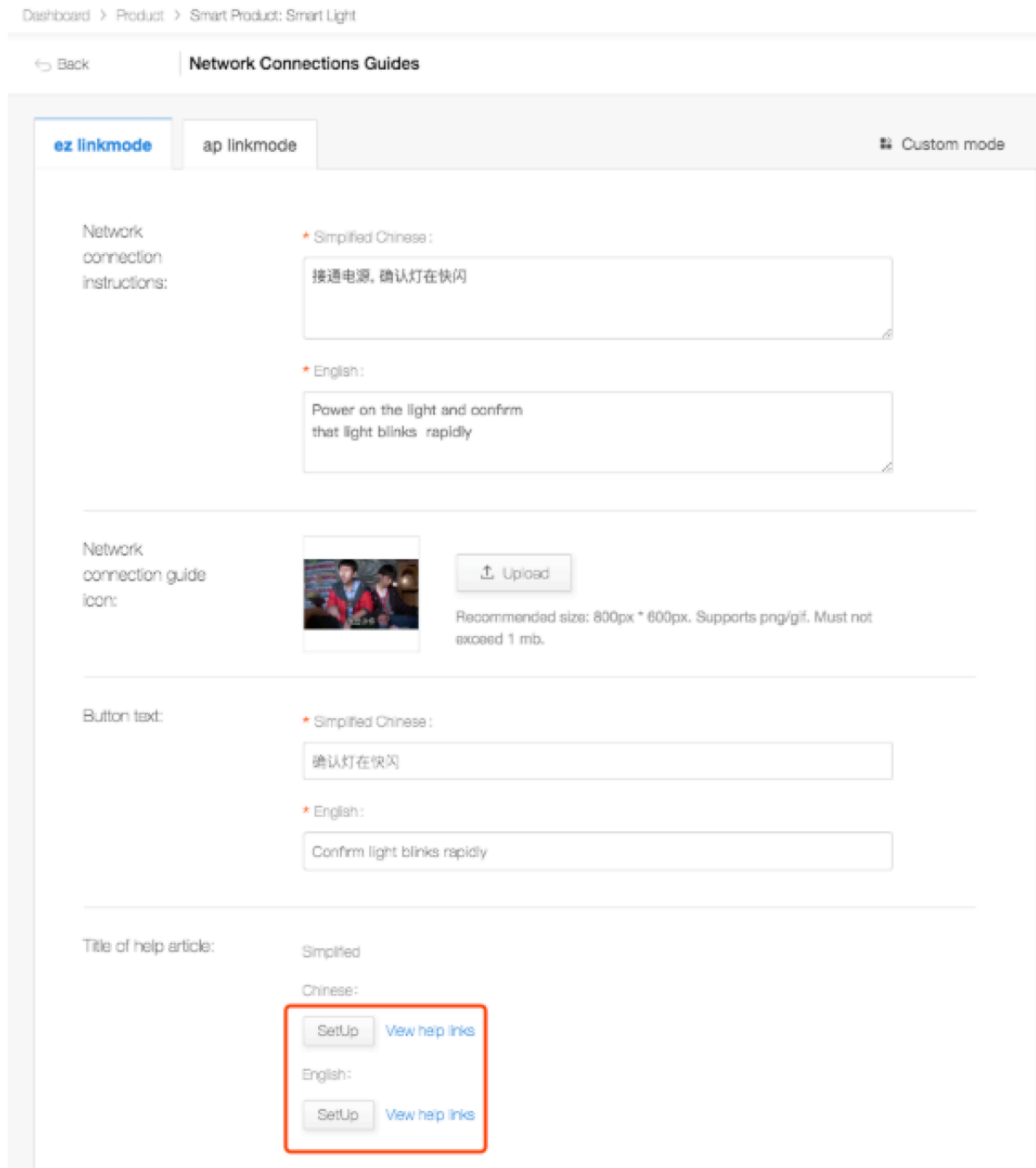
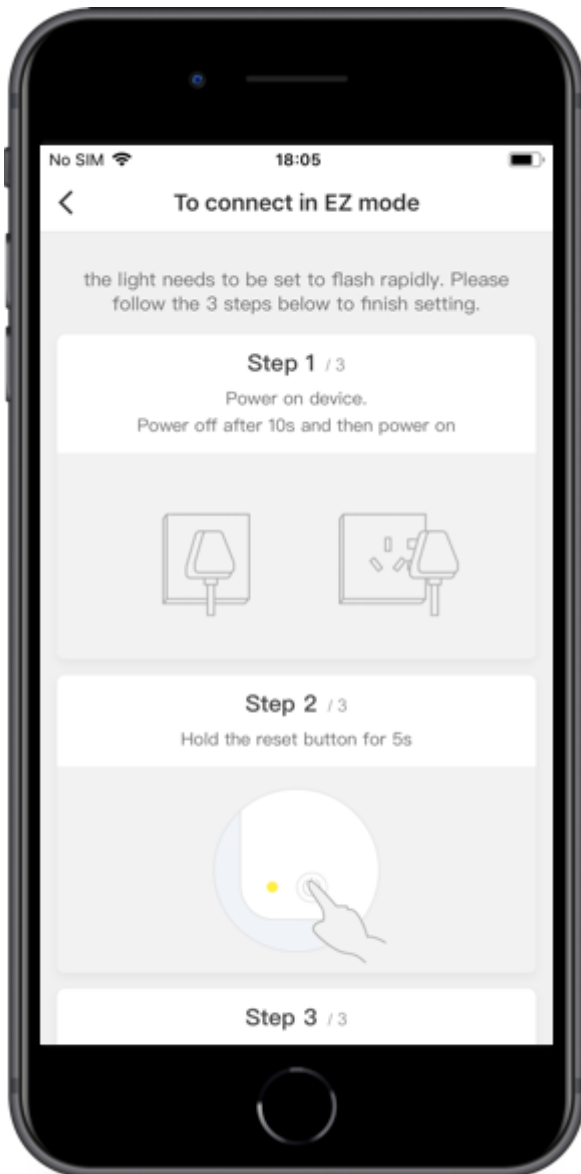

Figure 25: 15.png

App page display please refers to the following picture, taking Official template A V3.12.1 as an example



Note: Please remember to click the **Release** button after modifying this copy.

4.5 Configure protocols

Tuya provides **Reference document: Chinese,English,German,French,Japanese,Korean,P**
Chinese, you can click to download the reference. If you need multi-language
version, you can upload the modified document by clicking **Upload file(doc)**
according to the English translation.**(If you want to process for the App store,**
English must pass)

Attention: This Privacy Policy and User Agreement template is for your reference only and we make no representations or warranties regarding its accuracy, completeness, timeliness, validity, suitability and consequences. Your company need to make a comprehensive judgment on the above reference documents and conduct legal and compliance risk control.

Privacy Policy
User Agreement

Privacy Policy

The privacy policy is an important part of the app, you can modify the template we provide to complete the copy.[Disclaimer](#)

Reference document: [Chinese](#) [English](#) [German](#) [French](#) [Japanese](#) [Korean](#) [Portuguese](#) [Russian](#) [Spanish](#) [Traditional Chinese](#)

Management document ⓘ Tip: Uploading a document file and save it will take effect immediately, you can view the effect without rebuild the app.

Chinese:

* English: Not uploaded

[Upload other languages >](#)

4.6 Upgrade Notification:

When your App releases a version update, you can configure the personality push to the customer App here, and whether the App is to be updated depending on the customer.

4.7 Convert to SDK:

OEM support to transfer SDK, **Once the transfer is successful, it needs 7 * 24 hours to transfer back to the OEM from the SDK, please be careful**

5 Build App

If the configuration items are confirmed with no problem, you can build your App by clicking the button **Build now** at the bottom of the page. Please note that the build button has restrictions. Each version can be built 10 times a day and 30 times a month. Please use it with caution.

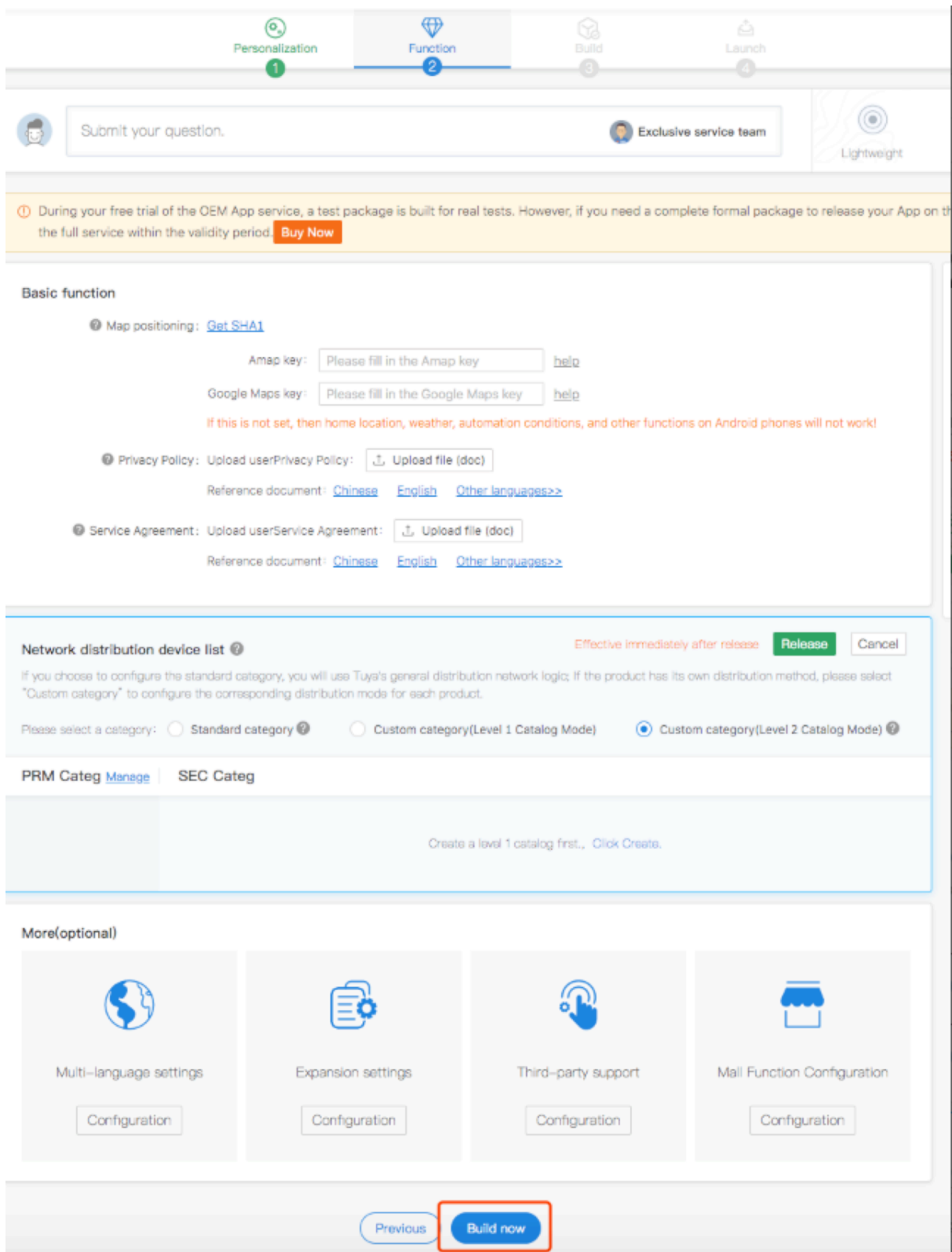
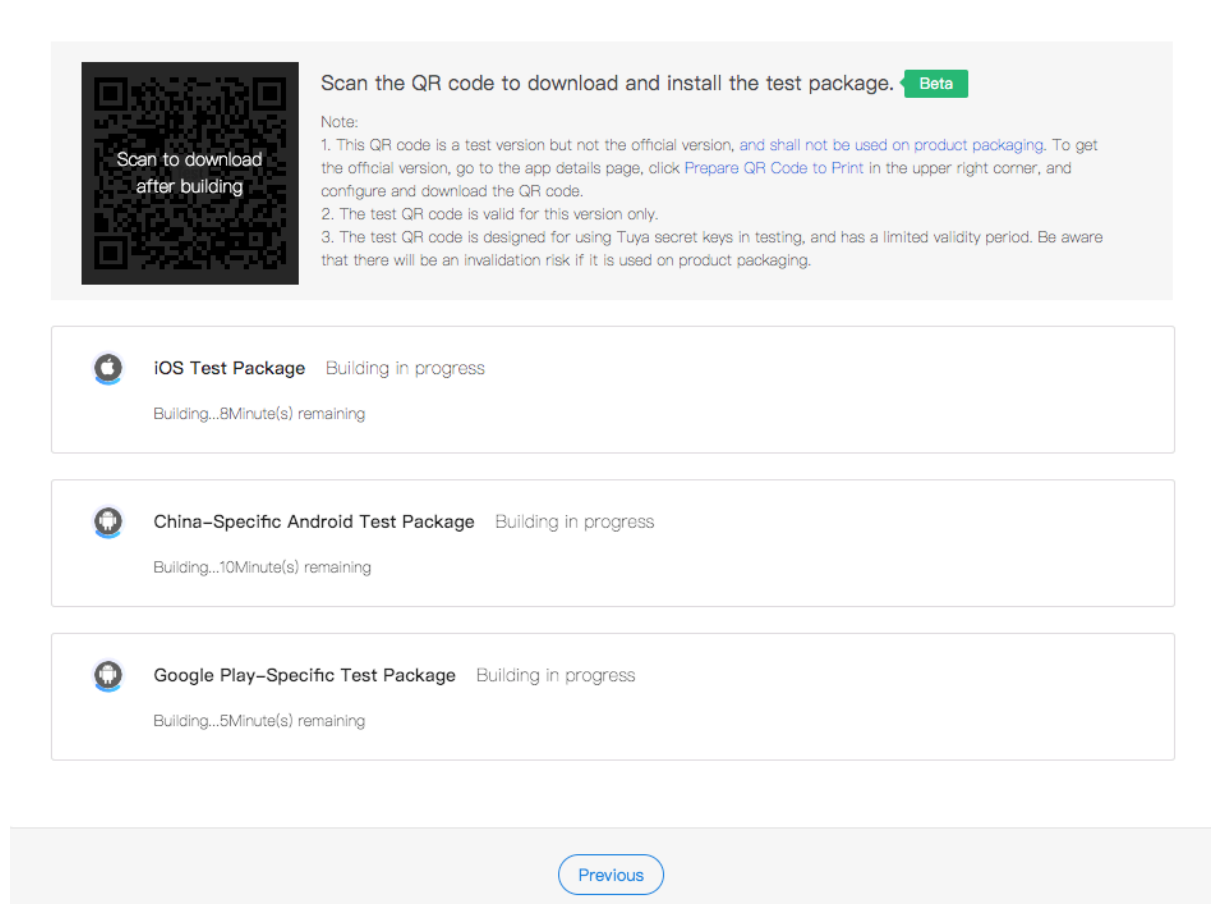

Figure 26: 21.png

After submitting the build application, the page status display is built. It takes 30-60 minutes to build the App, and the system automatically builds. The build result needs to be refreshed to check.



The screenshot displays a build status interface. At the top, there is a QR code with the text "Scan to download after building" overlaid. To the right of the QR code, the text reads "Scan the QR code to download and install the test package." followed by a green "Beta" badge. Below this, a "Note:" section contains three points: 1. This QR code is a test version but not the official version, and shall not be used on product packaging. To get the official version, go to the app details page, click [Prepare QR Code to Print](#) in the upper right corner, and configure and download the QR code. 2. The test QR code is valid for this version only. 3. The test QR code is designed for using Tuya secret keys in testing, and has a limited validity period. Be aware that there will be an invalidation risk if it is used on product packaging.

Below the note, there are three build progress cards:

- iOS Test Package** Building in progress
Building...8Minute(s) remaining
- China-Specific Android Test Package** Building in progress
Building...10Minute(s) remaining
- Google Play-Specific Test Package** Building in progress
Building...5Minute(s) remaining

At the bottom of the interface, there is a "Previous" button.

Figure 27: 33.png

After the build is completed, you can scan the QR code of the page and download the App to test. The QR code is only for testing the App of this version. Please do not paste this QR code on the product packaging or distribute it to customers;

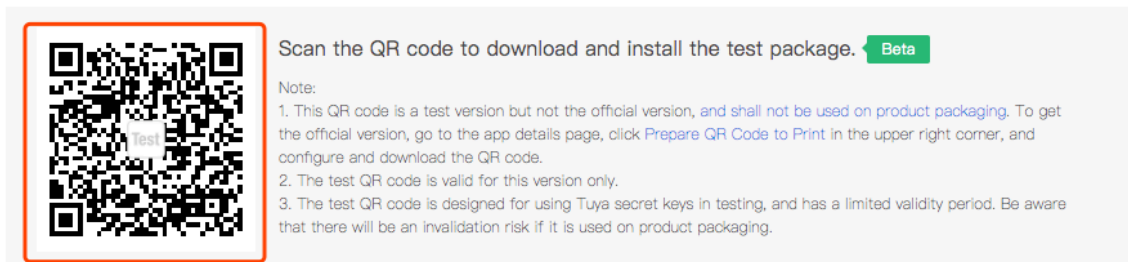
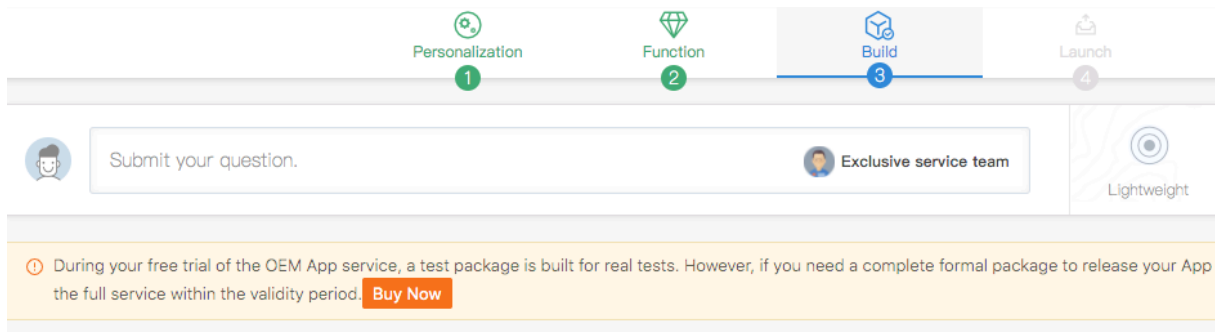

Figure 28: 66.png

5.4 If there is no result returned after the timeout, you can contact the Tuya staff for consultation, and the construction may fail due to incorrect configuration ; **If you encounter any problems during the configuration process, you can contact the Tuya customer service staff for help at any time through the page question entry;**

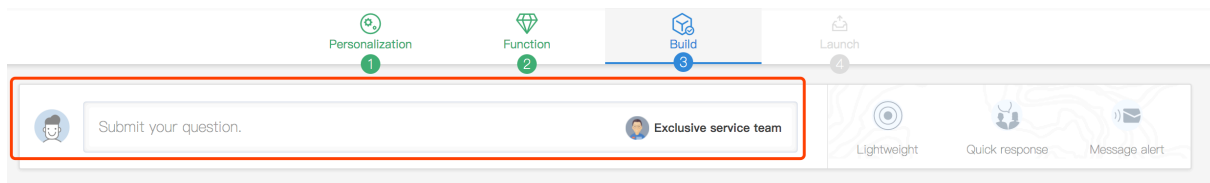

Figure 29: 55.png

6 Purchase App

If there is no problem with your App when testing, then you need to launch the App to the application market. If your App has not been paid, you will not be able to launch it ,please click the button **Buy now** to complete the payment according to the page prompt;

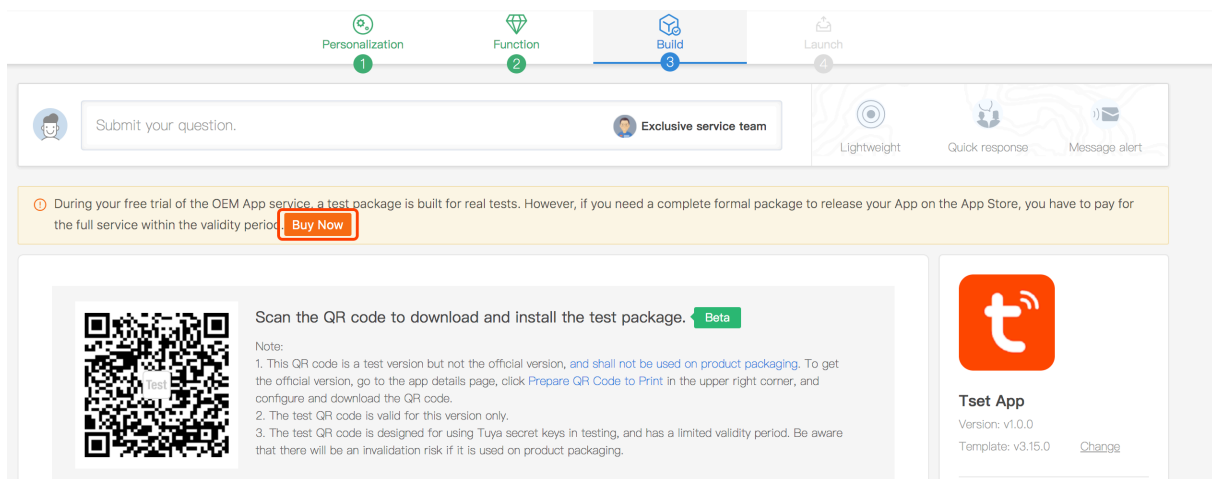

Figure 30: 111.png

Complete the purchase of App:

- **Select App:** here you can choose which App to pay for;
- **Payment info:** if your OEM App has been paid offline, please contact the business to apply for a coupon to purchase the OEM App ,and you can choose a coupon payment here;
- **Invoice:** you can choose according to your actual needs; if you need the invoice, please provide the billing information to your business after the service is completed.;

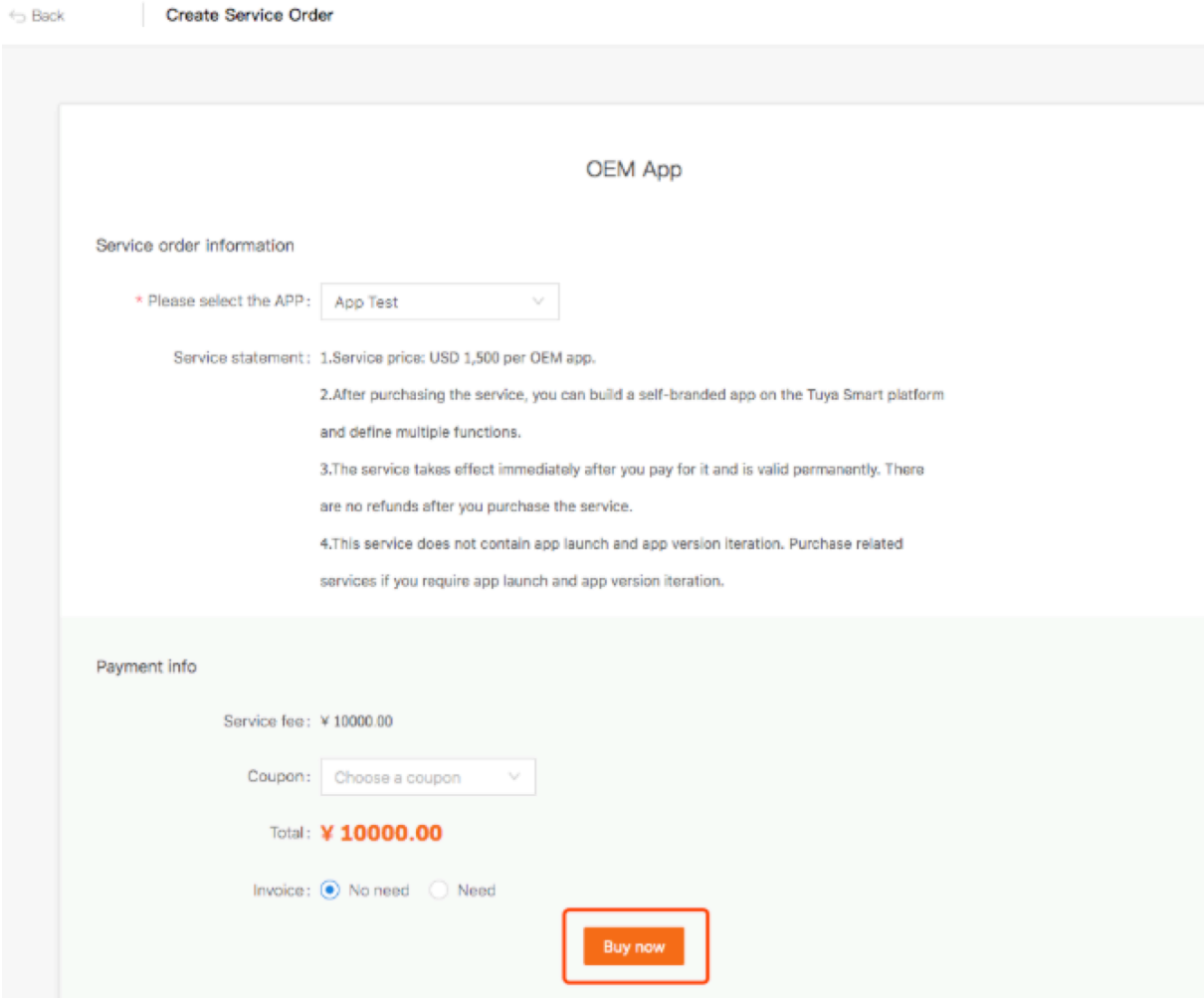

Figure 31: 24.png

You can pay with PayPal.

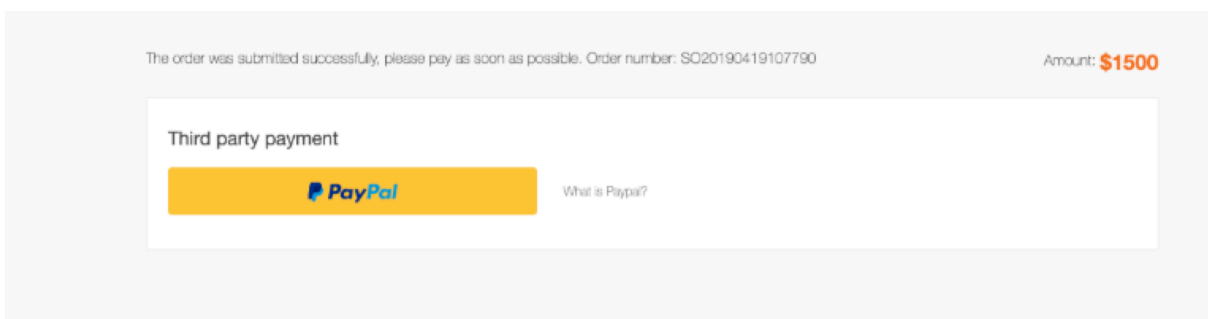

Figure 32: 25.png

After completing the payment, you can see the order information of all OEM App, click **View App** to return to the workbench to continue configuring your App.

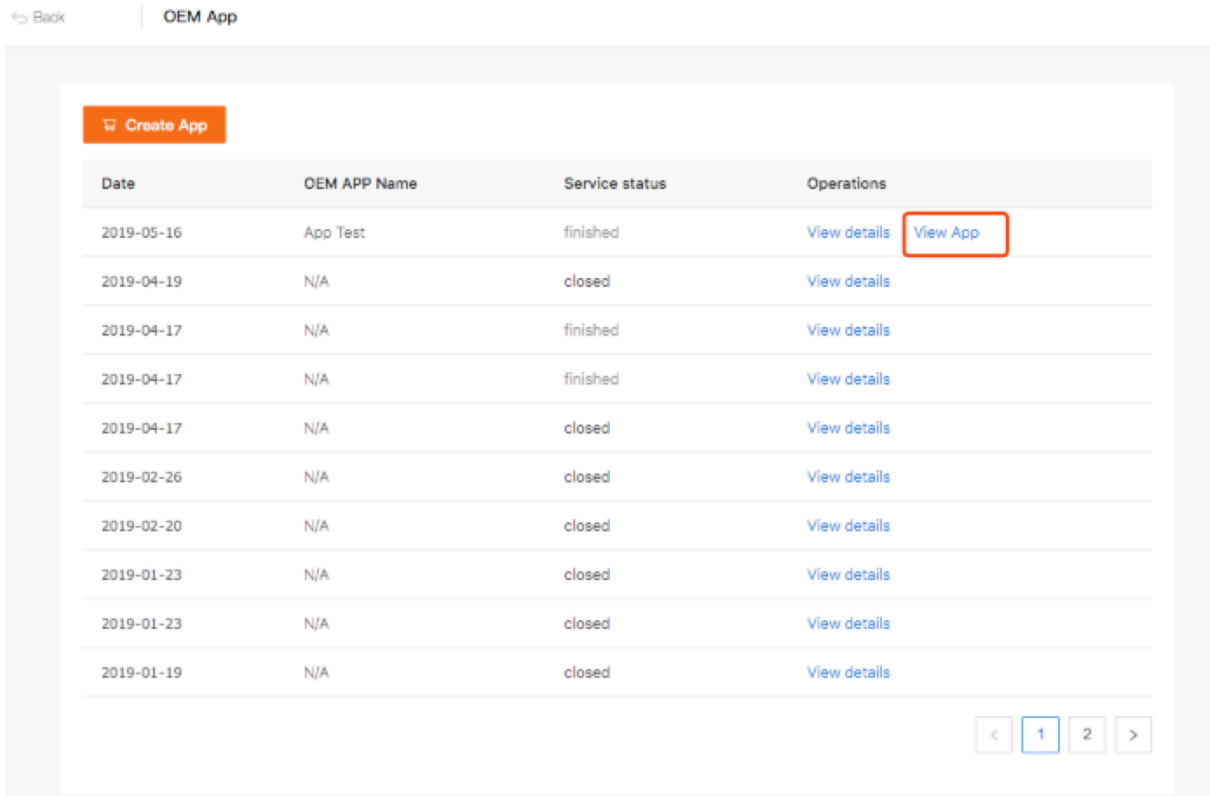

Figure 33: 26.png

Go back to Workbench version management page of the App, click the version number to enter the App configuration page and continue to complete the configuration.

The screenshot displays the 'App Test' interface. At the top left is the Tuya logo. The main header shows 'App Test' with a dropdown arrow. Below this, the 'Latest Version' is 'v1.0.0' and the 'App Certificate' is 'Not Configured' with a 'Modify' link. The 'iOS Package Name' is 'com.apptest.testsmart' and the 'Android Package Name' is 'com.apptest.testsmart'. On the right, there are icons for 'Registered User' and 'Active User', along with links for 'Download QR Code to Print' and 'Configure App Upgrade'.

A 'Create Version' button is present, with a message: 'There are no valid update and iteration opportunities under your account. To create a new version belongs to the OEM App software upgrade service, please [purchase](#) it see'.

A table lists the current version:

v1.0.0	Successful	Template:Official template A v3.9.5	You have 10 version creation times for today and 30 version creation times for the current month.	Creation Time: 2019-05-16 20:23 Modification Time: 2019-05-16 21:57
--------	------------	-------------------------------------	---	--

Figure 34: 27.png

7 Launch App

7.1 The Service Purchased on the Value-added Services Market before Launching

If there is no problem with the App test, you can click **I Want to Launch the App**.



Scan the QR code to download and install the test package. Beta

Note:

1. This QR code is a test version but not the official version, and shall not be used on product packaging. To get the official version, go to the app details page, click [Prepare QR Code to Print](#) in the upper right corner, and configure and download the QR code.
2. The test QR code is valid for this version only.
3. The test QR code is designed for using Tuya secret keys in testing, and has a limited validity period. Be aware that there will be an invalidation risk if it is used on product packaging.



iOS Test Package Build successful

1. Access to some services requires App Store's authorization, so relevant features are not available, such as obtaining the Wi-Fi name during network pairing.
2. This version is used for testing only. To launch your app on an app platform, go to the Launch page and download the installation package.
3. The test version uses Tuya secret keys. If the app fails during the test period, you will need to rebuild, download, and install it again.

Tuya will update the certificate in time after the expiration of the iOS test package certificate. You just need to repackage it after the expiration.



China-Specific Android Test Package Build successful

1. This version is used for testing only. To launch your app on an app platform, go to the Launch page and download the installation package.
2. The China-specific package provides more services than the Google Play-specific package, which are required by Chinese users, including push notification services (such as push channels of Umeng, Xiaomi, OPPO, vivo, Huawei, and Meizu), Amap, and social account login (QQ and WeChat account login).



Google Play-Specific Test Package Build successful

This version is used for testing only. To launch your app on an app platform, go to the Launch page and download the installation package.

Release app

Next, you need to upload the App which has been configured successfully to the major App markets. Once the app is approved, end users could use it. The review process and requirements of the different major app markets are different. For details, please refer to the following.

I Have Launched the App

I Want to Launch the App

Figure 35: 22.png

If you have already purchased the service, you will be prompted to enable the service, click **Ok**

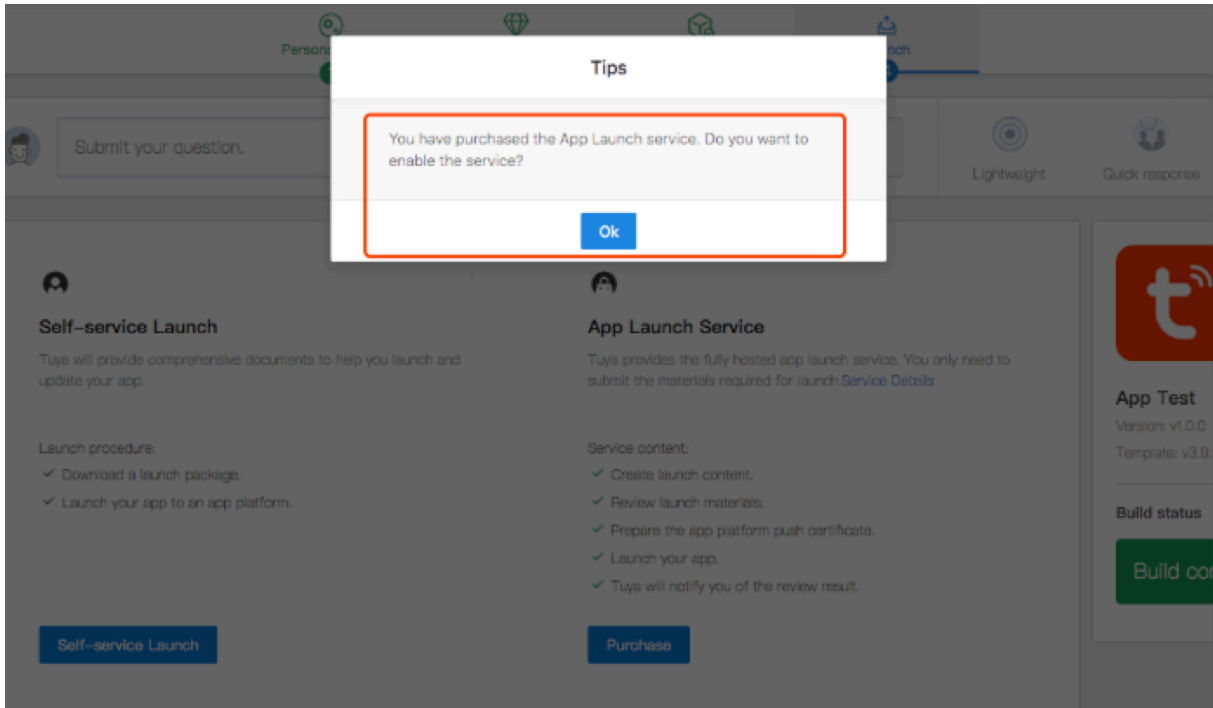

Figure 36: 28.png

At this point, you only need to wait for the staff of Tuya to contact you to provide the service. The following steps can be ignored, all of which can be configured by the staff of Tuya

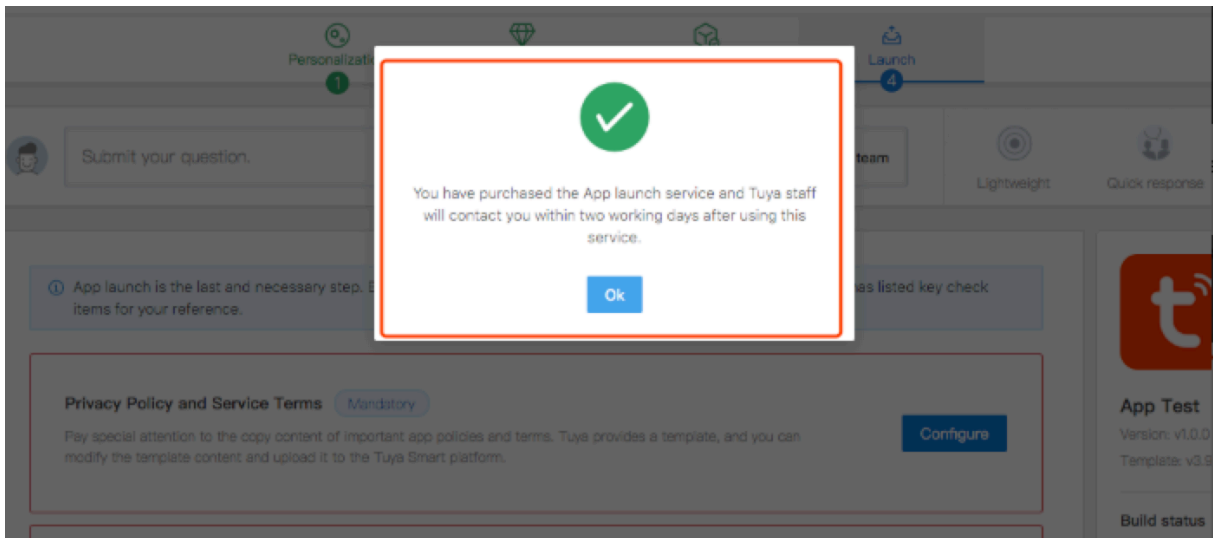

Figure 37: 29.png

7.2 Self-service Launch

(1) After clicking “I want to launch the App”, click **Self-service launch**, and then you can complete relevant operation according to the relevant operation manual by yourself.

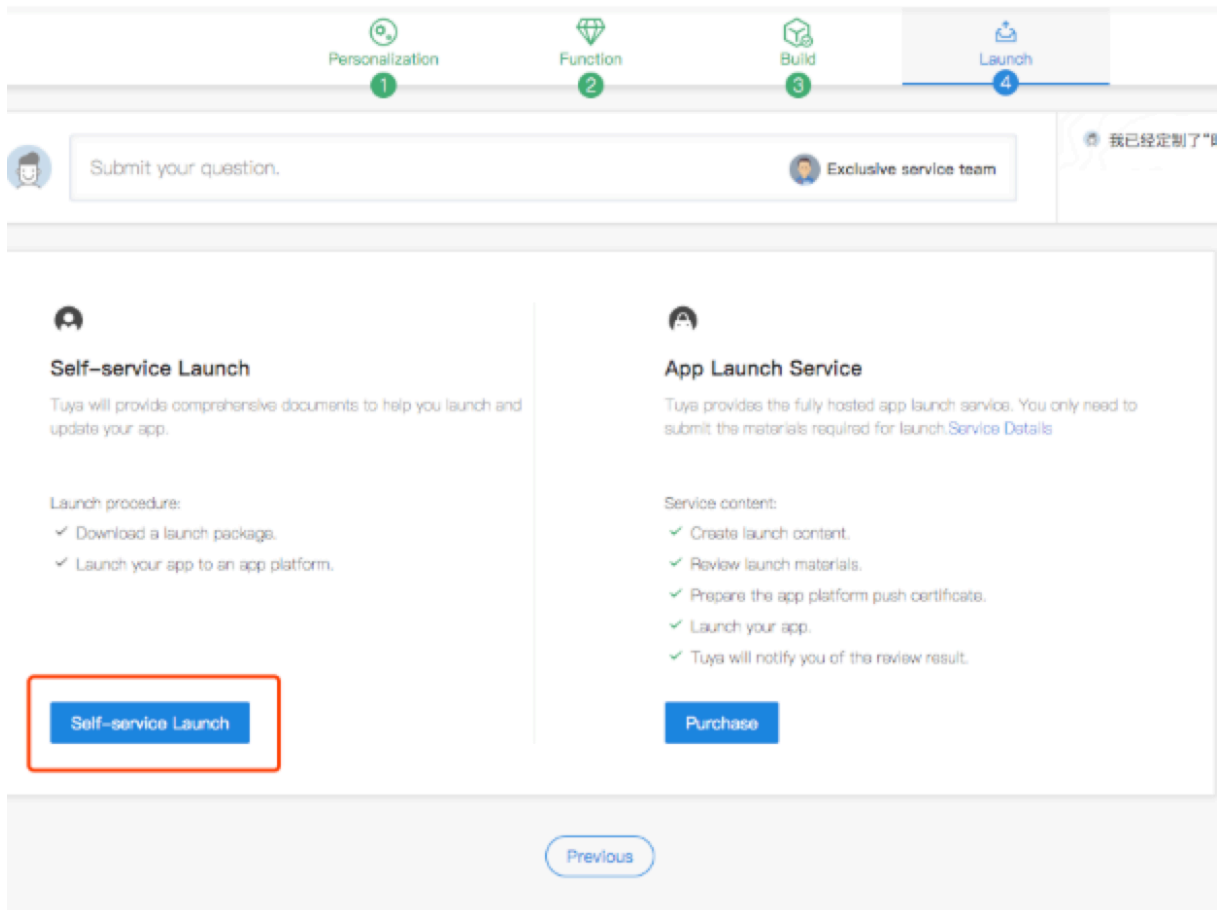

Figure 38: 30.png

(2) The system will automatically check the required items. When the App is not configured completely, the page will prompt you to configure. You can click the **Configure** button to complete it one by one. If you have any questions, please refer to the page help operation manual.

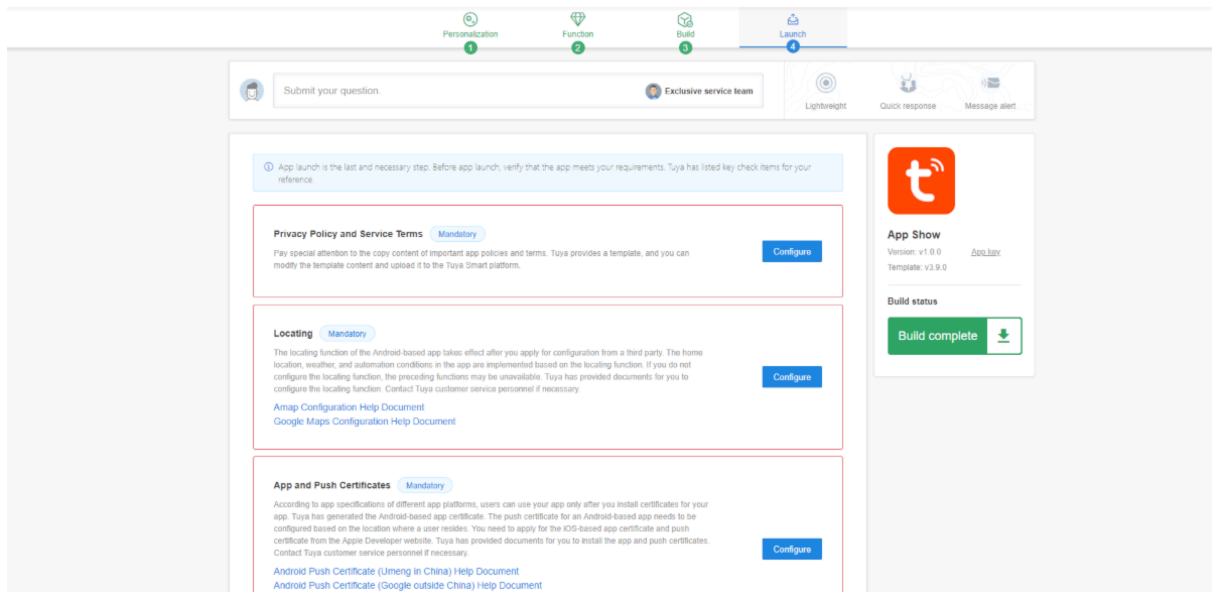

Figure 39: 31.png

(3) Any configuration item needs to be rebuilt as long as it is modified. After the configuration is complete, click **Configuration completed and rebuild**. **Because the number of builds is limited, it is recommended to apply the build once after the configuration is completed.**

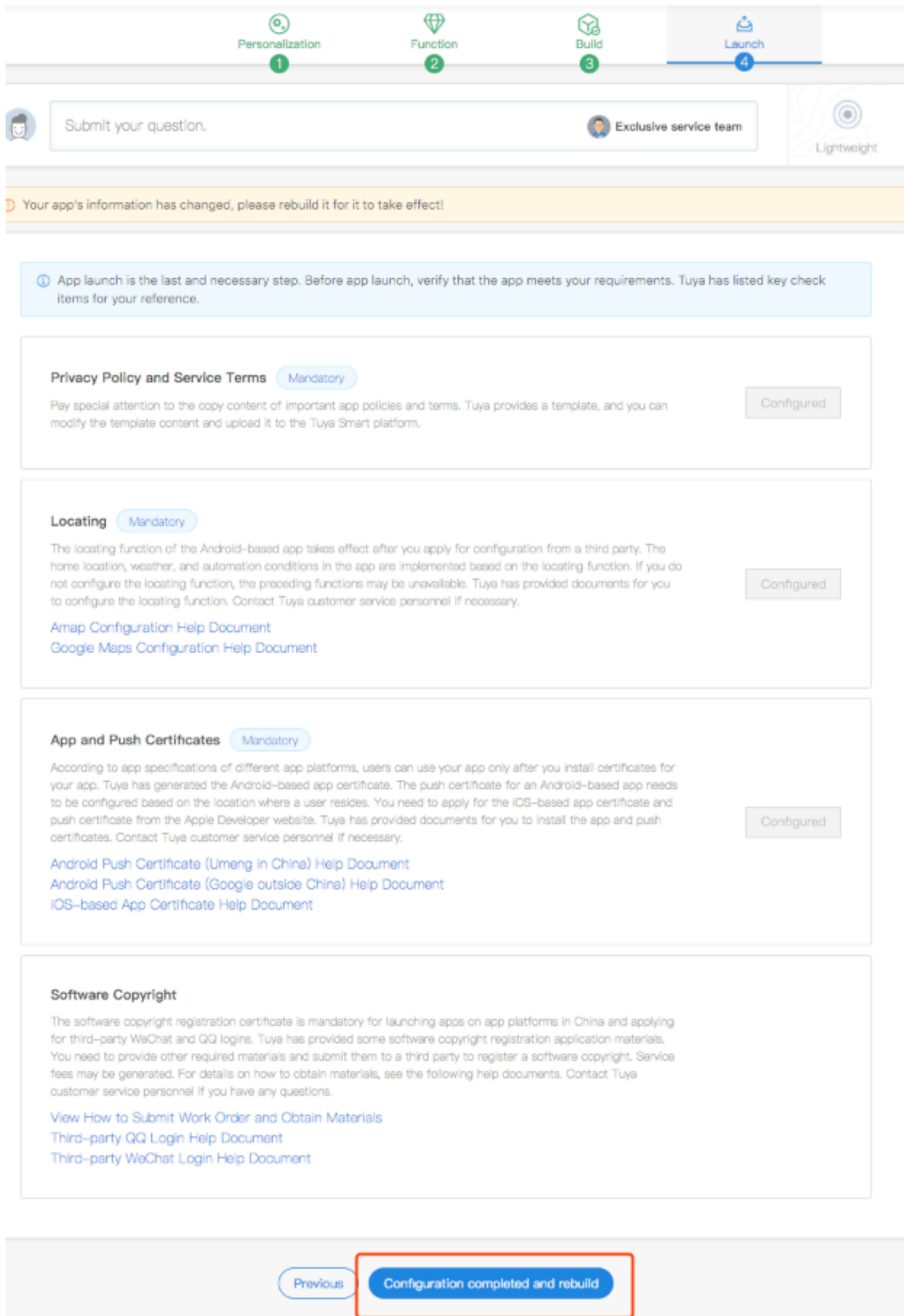

Figure 40: 33.png

(4) After build successfully, please uninstall the previously installed App and re-download to confirm whether the push function of Android and the map function are effective (iOS will take effect after passing the Apple review). If there is no problem, please click **I want to launch the App**→ **Self-service launch** → **configuration completed**;

(5) Please confirm the App configuration item before launching. Once the App is launched, you cannot modify configurations of the current App version, please confirm and then click **Ok**;

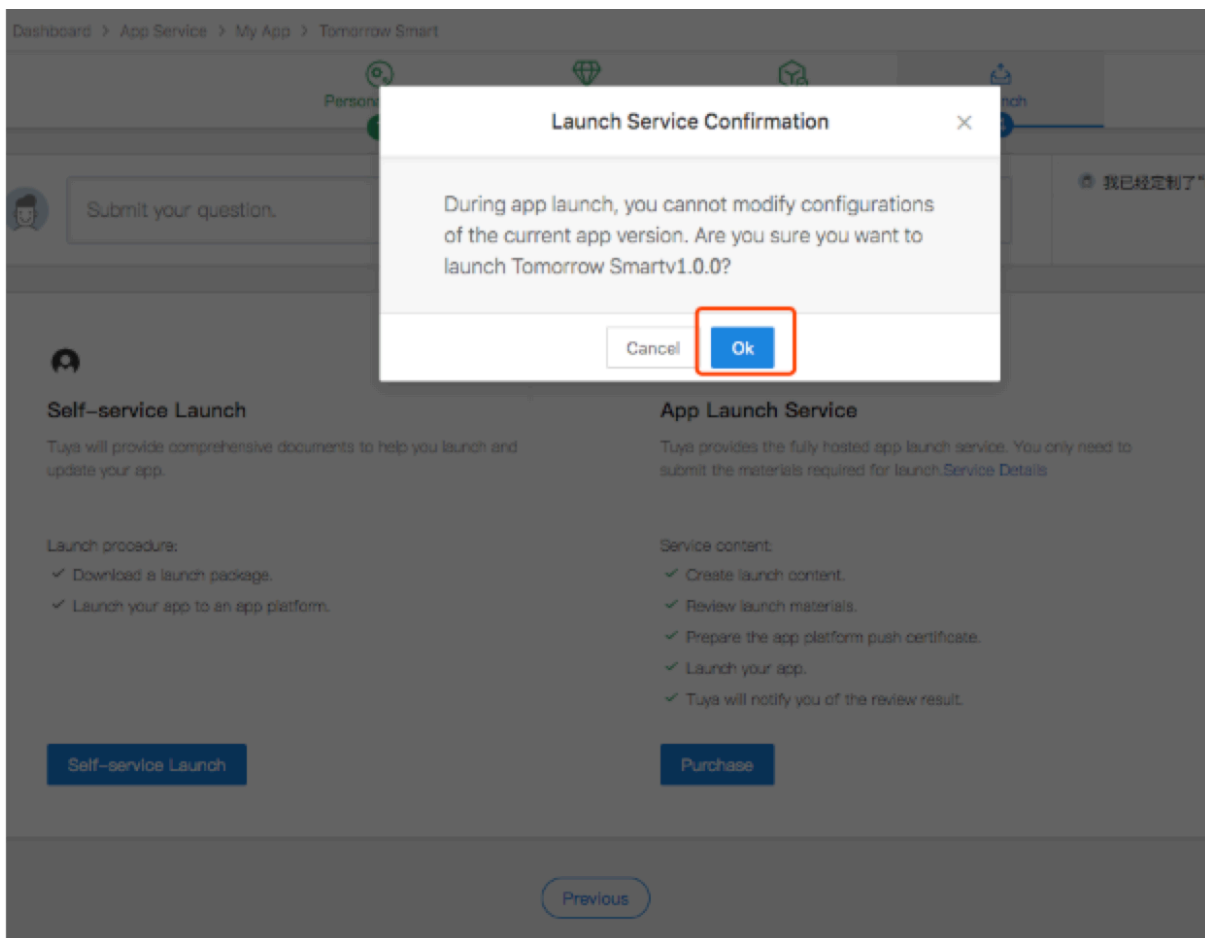

Figure 41: 36.png

(6) App file package can be downloaded by yourself. The specific application market can refer to the guidance. **Since the iOS review is very strict, please read the operation manual carefully and launch your application according to the specifications** . If you encounter any problems during the above process, you can submit your question at the current page . After approving the market review,

please click [Launched](#) button on the bottom of the page to complete it;

Personalization 1
Function 2
Build 3
Launch 4

Submit your question.

Exclusive service team

定制固件版本更新

Congratulations, you have obtained the launch package. Launch your app based on the following help documents!(If you need to release the app to Google Play, be sure to use the "Applied For Google Play").

Get the Launch Package

iOS Launch Package

Description: Provide a complete iOS installation package for the App Store

Use Range: App Store only

Documentation: [Releasing iOS App help documentation](#) [Apple Store Version Update help documentation](#)

Download: [Download for iOS](#)

Android Launch Package

	Android–Mainland China	Applied For Google Play
Description:	Contains the most complete capabilities. Compared with the Google Play version, it has more services required by domestic users in China, including push services (such as Umeng,XG Push, Xiaomi, OPPO, vivo, Huawei, Meizu push channels), maps (Amap), social login (QQ login, WeChat login) service module	Compared with the Android–Mainland China version, it does not include the services required by Chinese domestic users. Advantage: The installation package file is smaller, which can improve the probability of approval in the Google Play market.
Use Range:	Recommended for listing in domestic Android app stores	1.Recommended for publishing on Google Play 2、 Local Android app stores overseas
Documentation:	No data	Google Play Publishing help documentation Google Play Version Update help documentation
Download:	Download for Android–Mainland China	Download for Google Play

If you only want to launch your app on one app platform in China, select [MyApp](#). You can also select multiple app platforms to allow users to conveniently download your app.

Launch on an App Platform

1. 360 Mobile Assistant	2. Huawei App Market	3. Oppo Software Store
4. SnapPea	5. Mumayi Market	6. Sogou Mobile Assistant
7. Anzhi Market	8. Tencent MyApp	9. Alibaba Cloud Developer Platform
10. Baidu Mobile Assistant (91 Assistant/Android Market)	11. AppChina	12. Estore
15. Eloquent Market	13. Mi Store	14. PP Assistant
	16. Meizu App Store	17. Lenovo Le Store

Remarks: The preceding information is not updated in real time. To obtain the latest materials, visit the official websites of the app platforms.

Select Launch Mode
Launched

Figure 42: 英文.png

7.3 Purchase Service

(1) After clicking **I want to launch the App**, click **Purchase**

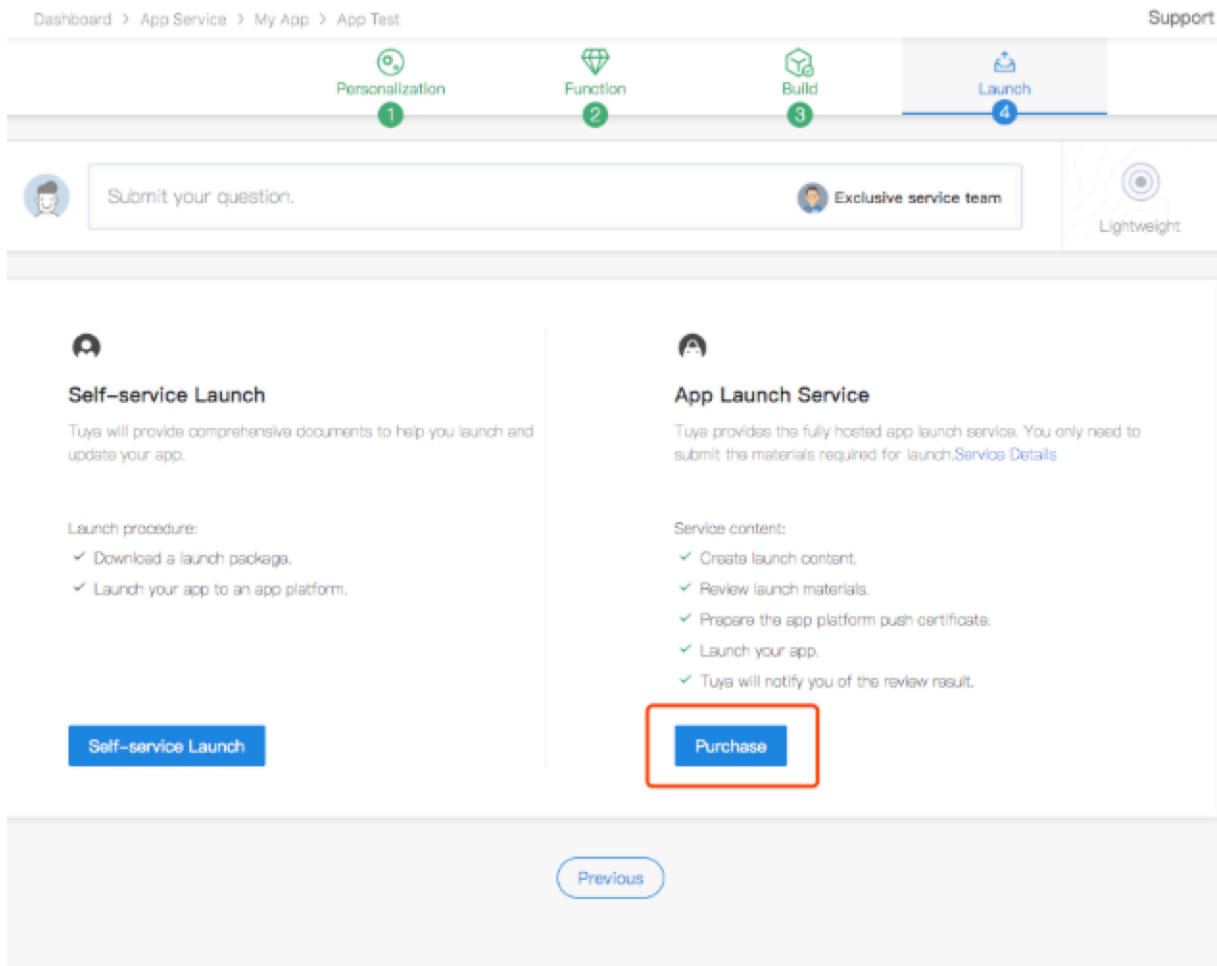

Figure 43: 37.png

(2) Complete the purchase of App launching

- **Select App:** here you can choose which App to purchase for launching;
- **application service:** Tuya offers three different application service of launching, you can choose according to your actual business needs;
- **Download Template :** please click here to download the form. The information in the form is the required information on the application market. Please fill in the information carefully. The staff of Tuya provide launch service according to the information you provided;

- **Upload the completed template:** upload your completed form here;
- **Contact:** please fill in your phone number;
- **Email:** Please fill in your email address;
- **Payment info:** if your App has been paid offline, please contact the business to apply for a coupon to launch and you can use it to pay here;
- **Invoice:** you can choose according to your actual needs; if you need the invoice, please provide the billing information to your business after the service is completed.

← Back | Create Service Order

App Launch

Service order information

* Please select the APP: App Test Version: 1.0.0

* Application service: Package A

Service provided: App launch on the App Store (in and outside China) and Google Play (outside China).

Service Description: 1.Launch service for one app
2.Service content: making the content to be launched, reviewing materials for app launch application, applying for a message push certificate from the app platform, launching your app, and notifying you of the application result.
3.Initial app launch and app update release
4.The app platform determines whether to approve an app launch application. Tuya provides professional solutions to improve the success rate. Because allocated service resources cannot be reclaimed, the service fee is not refundable.

Download template: [App Launch — Customer Application Template.xlsx](#)

* Upload the completed tem Upload

Only xls,xlsx,doc,docx format uploads are supported, shall not exceed 10 mb

* Contact:

* Email:

Remark:

Payment info

Service fee: \$ 300.00

Coupon: Choose a coupon

Total: **\$ 300.00**

Invoice: No need Need

Buy now

Figure 44: 38.png

(3) Due to the review of iOS is very strict, you need to provide an App operation demo video before submitting the review

- **Send samples:** you can send samples to Tuya for making operation video, please do not send the devices that is easy to be rejected by Apple, for example, bulbs, lights and plug ;
- **No need to send any sample:** you can also make operation video by yourself according to the example provided by Tuya.

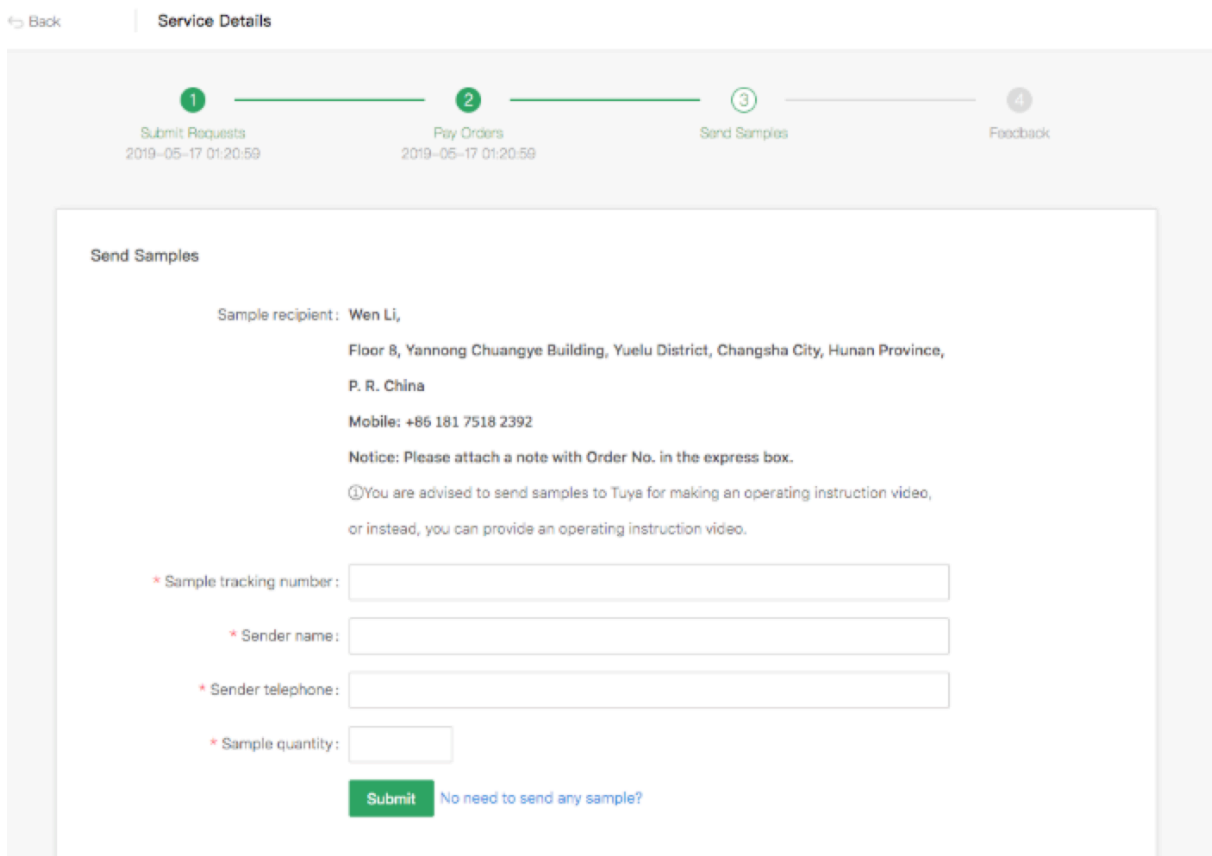

Figure 45: 39.png

At this point, you only need to wait for the staff of Tuya to contact you to provide the service. The following steps can be ignored, all of which can be configure

8 Subscription

OEM App supports version update . After enable the **subscription**, when a new template is published, the system will automatically send email with update instructions to you.(Multiple email addresses are separated by “,” , You can set up 30 email addresses)

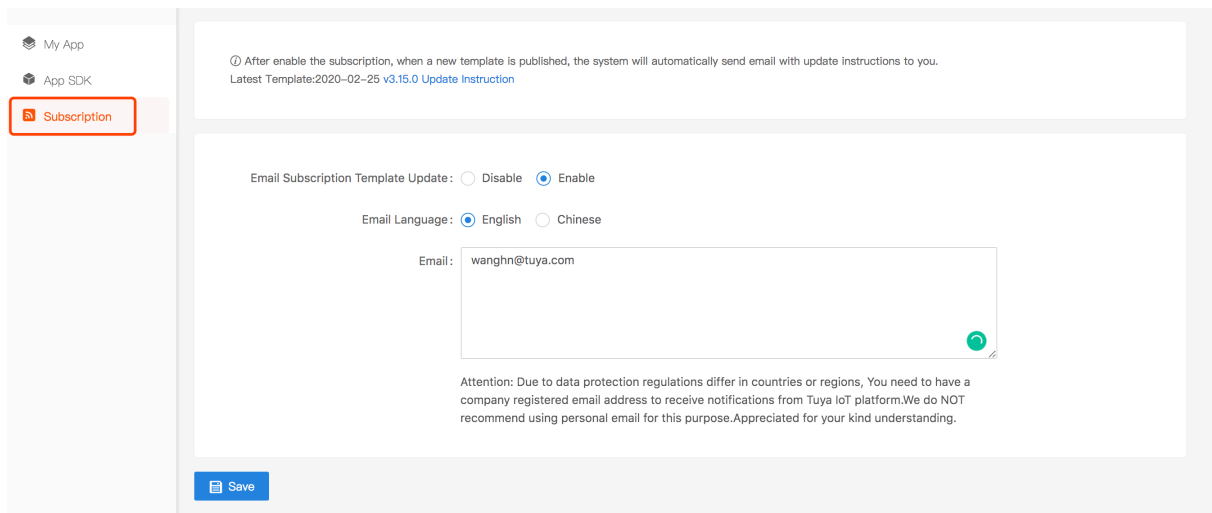

Figure 46: 1234.png